

Embarcadero Labs



2440-2470 EMBARCADERO WAY & 2275 EAST BAYSHORE RD
PALO ALTO, CA

FOR LEASE

CLASS A PURPOSE-BUILT LAB
& OFFICE SPACE

CBRE

PROPERTY HIGHLIGHTS



BRAND-NEW
PURPOSE-BUILT
CLASS-A SPEC LABS



HIGHLY EXPERIENCED LIFE
SCIENCE DEVELOPER



IMMEDIATE ACCESS
TO US HIGHWAY 101



ATTRACTIVE
NEW OUTDOOR
PATIO AREAS



AVAILABILITY:
EMBARCADERO WAY -
7,441-14,883 SF
2275 EAST BAYSHORE -
12,564 SF



AVAILABLE
NOW



EFFICIENT AND
FLEXIBLE DESIGN



PARKING RATIO
OF 3.00/1,000



CLOSE PROXIMITY
TO STANFORD
UNIVERSITY & STANFORD
RESEARCH PARK



ALL-NEW BUILDING MEP
SYSTEMS INCLUDING
BACKUP GENERATORS





FOR LEASE

SPEC LAB FLOOR PLAN | 2450

EMBARCADERO LABS
2440-2470 EMBARCADERO WAY, PALO ALTO, CA

PROPERTY FEATURES

- 14,883 SF Divisible to 7,441 SF
- Purpose-Built Brand-New Spec Labs with Highly Functional 50/50 Lab Office Ratio
- Flexible Portable Casework with Ceiling Utility Drops
- Dedicated TC or Lab Support Rooms
- Two Chemical Fume Hoods per Building
- Shipping and Receiving Areas Adjacent to Each Lab
- Office Space Built Out with Conference, PO/Breakout Rooms and Kitchen/Break Area
- High Quality New Restroom Core with Showers
- Available Now
- Power : 1,200 Amps
- Office Furniture not Included
- House CDA and Vacuum
- 100 kw backup generator

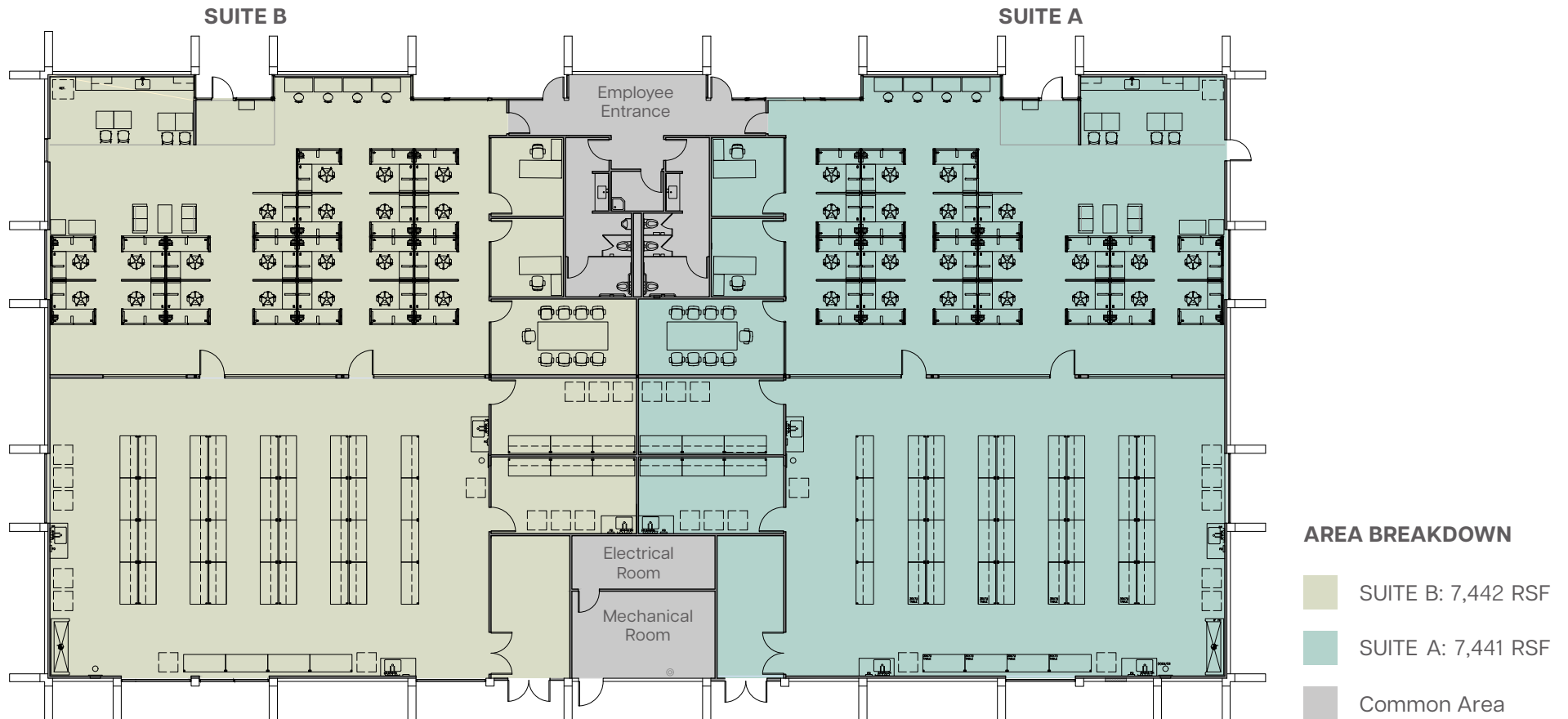

*Office Furniture not included

FOR LEASE

SPEC LAB FLOOR PLAN | 2275

2275 BAYSHORE
2275 EAST BAYSHORE RD, PALO ALTO, CA

PROPERTY FEATURES

- 12,564 SF
- Purpose-Built Brand-New Spec Lab with Highly Functional 50/50 Lab Office Ratio
- Flexible Portable Casework with Ceiling Utility Drops
- Dedicated TC, Lab support and Equipment Rooms
- One Chemical Fume Hood
- Shipping and Receiving Area Adjacent to Lab
- Office Space Built Out with Multiple Conference, PO/Breakout Rooms and Kitchen/Break Area
- Near Term Future Expansion Space Available
- Available Now
- Power : 800 Amps
- House CDA and Vacuum
- New Emergency Backup Generator

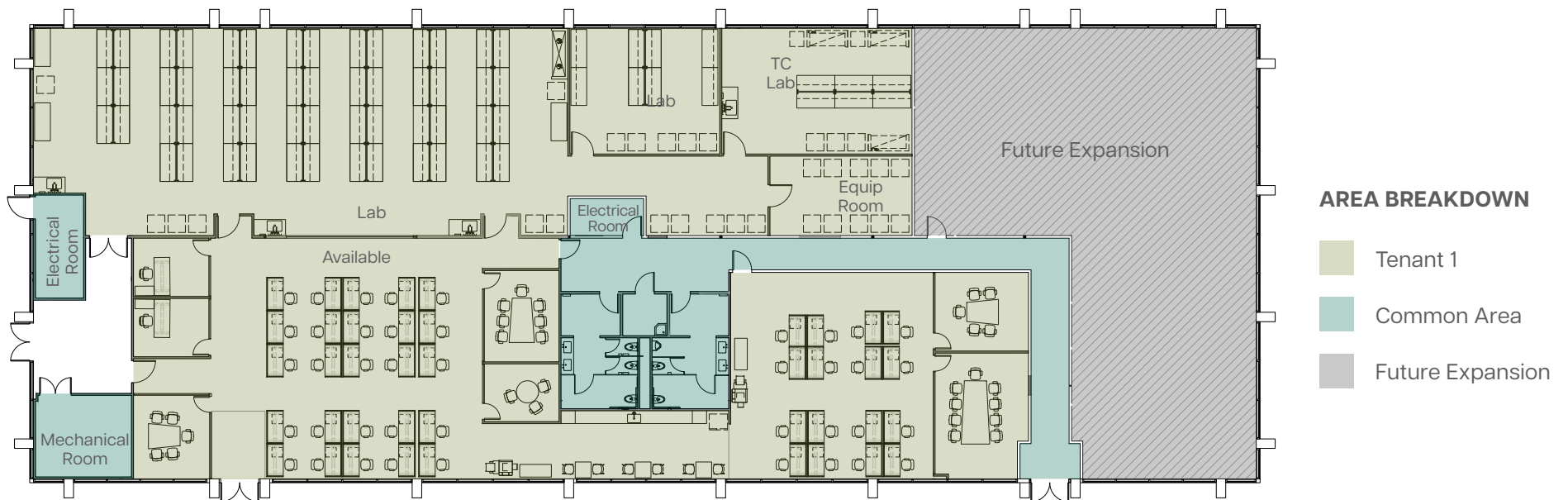

FOR LEASE

2275 BAYSHORE
2275 EAST BAYSHORE RD, PALO ALTO, CA



LOCATION MAP

2440-2470 EMBARCADERO WAY &
2275 EAST BAYSHORE RD, PALO ALTO, CA



Embarcadero Labs

2440-2470 EMBARCADERO WAY &
2275 EAST BAYSHORE RD, PALO ALTO, CA



James Bennett
Lic. 00869074
+1 415 377 8948
james.bennett@cbre.com

Gregg Domanico
Lic. 00996779
+1 415 215 5218
gregg.domanico@cbre.com

Michael Domanico
Lic. 01944774
+1 650 430 1464
michael.domanico@cbre.com

CBRE

lpi BioScience Property
Investments

©2025 CBRE, Inc. All rights reserved. This information has been obtained from sources believed reliable but has not been verified for accuracy or completeness. You should conduct a careful, independent investigation of the property and verify all information. Any reliance on this information is solely at your own risk. CBRE and the CBRE logo are service marks of CBRE, Inc. All other marks displayed on this document are the property of their respective owners, and the use of such logos does not imply any affiliation with or endorsement of CBRE. Photos herein are the property of their respective owners. Use of these images without the express written consent of the owner is prohibited.