

801 5th Avenue, Seattle, WA

F5 Tower

Up to 115,149 RSF
Available for Sublease

**Exceptional
Experiences**

CBRE

F5
TOWER

Space Highlights



 Plug & play space with high-end finishes & FFE

 Available in ±19,000 RSF full floor increments

 Master lease is through September 2033; shorter term possible







 Perimeter workstations (72") with internal meeting spaces and private offices

 Column-free interior; 9'6" full-height windows

Discover an unparalleled sublease opportunity in the heart of downtown Seattle. Experience the inspiring panoramic views from your office, encompassing Elliott Bay, the Olympic and Cascade ranges, Mount Rainier, and the vibrant cityscape. This isn't just an office; it's a fully furnished, turn-key experience, perfect for tech-centric companies looking for growth.



Space Availability

| Plans | Floor | Size | Workstations | Available | Tour |
|---|-------|------------|--------------|-----------|---|
|  | 23 | 18,636 RSF | 98 | Now |  |
|  | 24 | 19,199 RSF | 107 | Now | |
|  | 26* | 19,334 RSF | 94 | Now | |
|  | 27* | 19,352 RSF | 87 | Now | |
|  | 28* | 19,338 RSF | 78 | Now | |
|  | 29* | 19,290 RSF | 102 | Now | |

* Floors 26-29 have interconnecting stairs

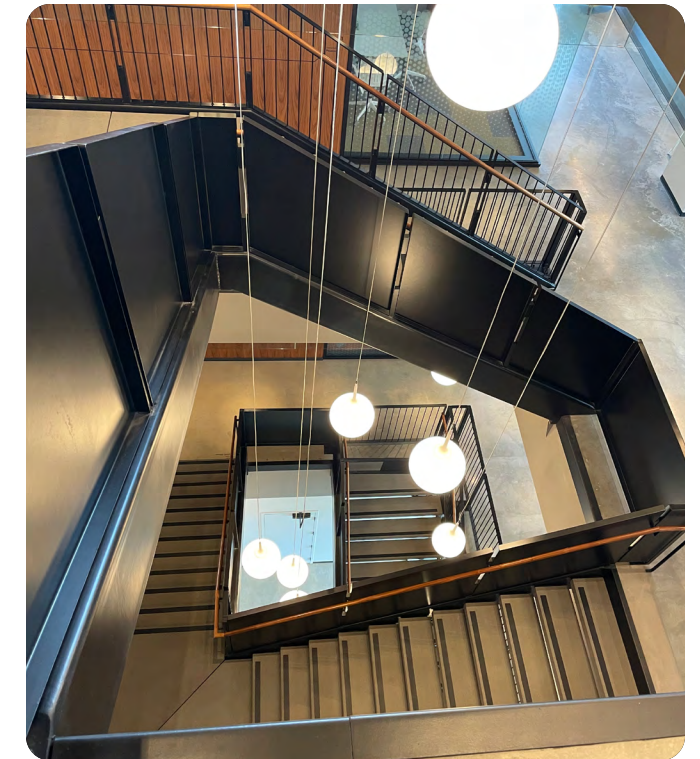

Floor 23

18,636 SF | 98 Workstations | Available Now

Single floor opportunity



Virtual Tour



Floor 27*

19,352 SF | 87 Workstations | Available Now

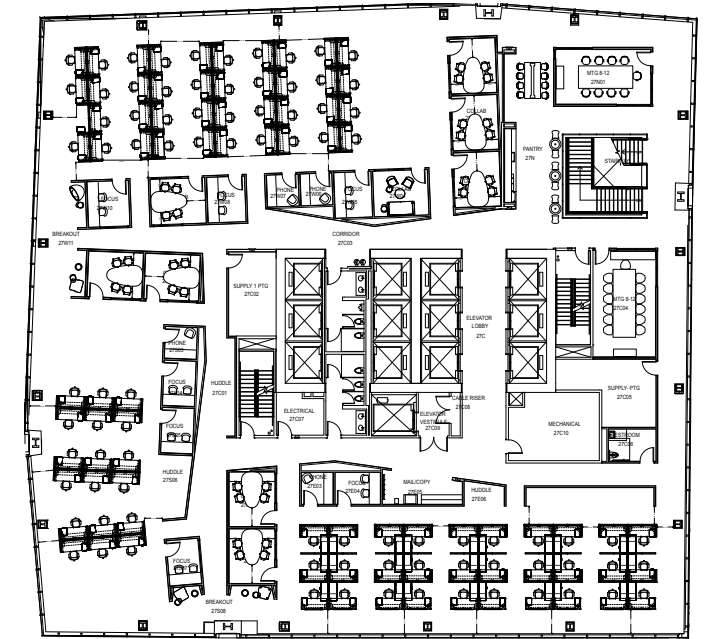

Floor 24

19,199 SF | 107 Workstations | Available Now

Single floor opportunity

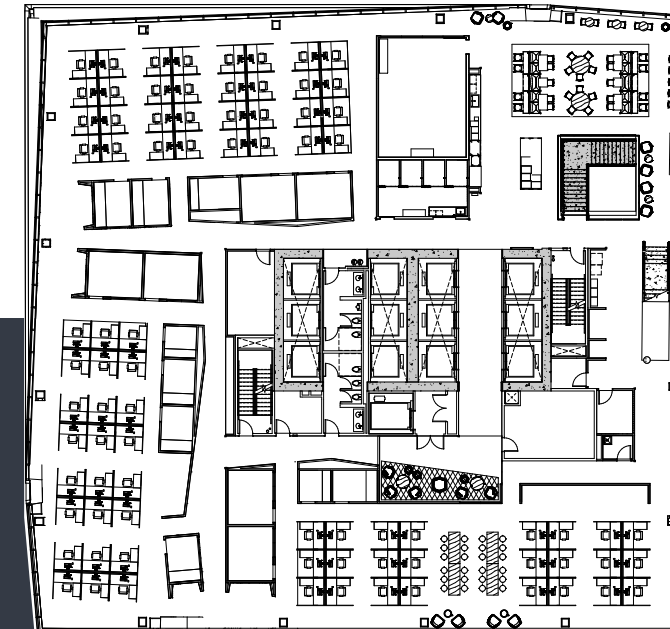
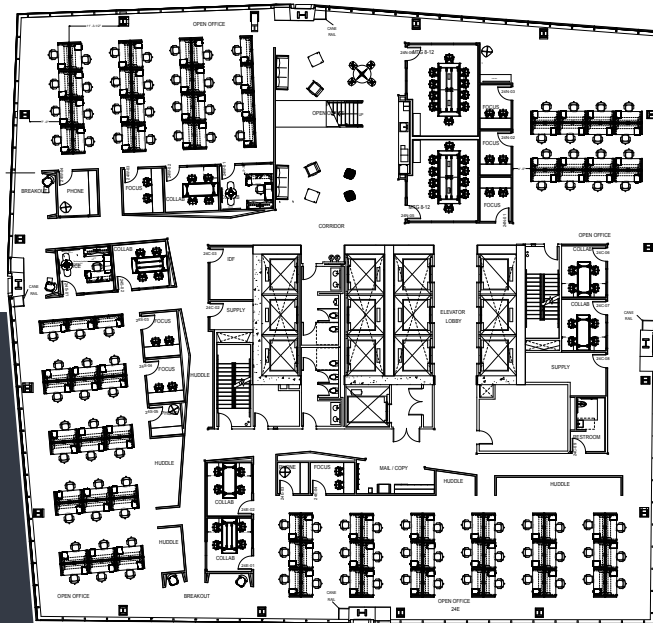

Floor 28*

19,338 SF | 78 Workstations | Available Now

Floor 26*

19,334 SF | 94 Workstations | Available Now

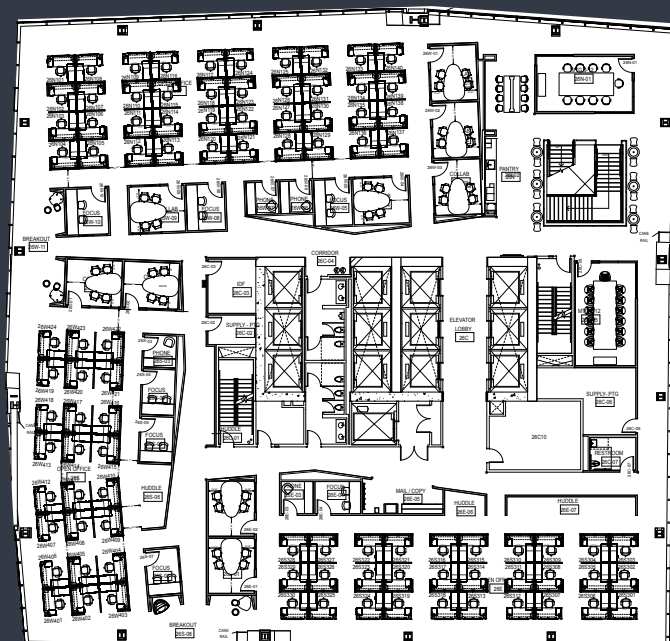

Floor 29*

19,290 SF | 102 Workstations | Available Now

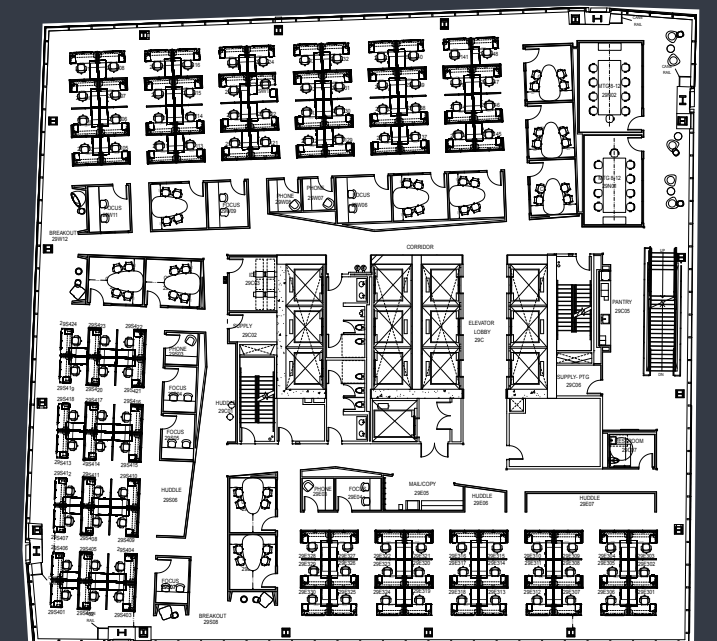

* Floors 26-29 have interconnecting stairs

**Load Factor: 9.9% or less per floor

* Floors 26-29 have interconnecting stairs

**Load Factor: 9.9% or less per floor

Building Highlights



Security:

- 24/7 security
- One secure point of entry on 5th Avenue
- 12 highspeed destination dispatch elevators
- Turnstile entry to elevators



Parking:

- 1 stall per 2,000 RSF (9 stalls per floor)
- \$406 per month
- 10 EV charging stations



Amenities:

- Secure bike storage
- Showers
- Day-use lockers
- F5-maintained fitness center on Floor 20
- Dedicated reception desk accessible for all building occupants
- Adjacent to Lotte Hotel and The Sanctuary event space



Local Attractions

1. Amazon Spheres
2. Westlake Center
3. Pacific Place
4. Convention Center
5. Seattle Waterfront
6. Pike Place Market
7. Seattle Art Museum
8. Seattle Public Library
9. The Sanctuary/Lotte Hotel



Corporate Neighbors

1. Zillow, Oracle, JP Morgan Chase
2. Remitly, Russell Investments, KPMG
3. Qualtrics, Indeed, Anduril, Bungie, Doordash
4. Uber, Lululemon, Accenture
5. Docusign
6. Disney
7. Pitchbook
8. Stripe, EY
9. 98point6, Amperity, Hiya
10. Avalara

Major Transit Lines

- Link Light Rail Tunnel
- Ferry Line
- Major Downtown Bus Thoroughfare
- King County Metro RapidRide G Line



**Up to 115,149 RSF
Available for Sublease**

F5 Tower

801 5th Avenue, Seattle, WA

Matt Walters

Executive Vice President
+1206 850 8426
matt.walters@cbre.com

Brian Biege

Executive Vice President
+1425 922 2610
brian.biege@cbre.com

Jacob Hamlin

Vice President
+1425 319 7252
jacob.hamlin@cbre.com

Liv McShane

Client Services Coordinator
+1206 306 4844
liv.mcshane@cbre.com

f5tower.cbre-properties.com



© 2026 CBRE, Inc. All rights reserved. This information has been obtained from sources believed reliable but has not been verified for accuracy or completeness. CBRE, Inc. makes no guarantee, representation or warranty and accepts no responsibility or liability as to the accuracy, completeness, or reliability of the information contained herein. You should conduct a careful, independent investigation of the property and verify all information. Any reliance on this information is solely at your own risk. CBRE and the CBRE logo are service marks of CBRE, Inc. All other marks displayed on this document are the property of their respective owners, and the use of such logos does not imply any affiliation with or endorsement of CBRE. Photos herein are the property of their respective owners. Use of these images without the express written consent of the owner is prohibited. CPMF F5 Tower __ BRO _v11 _REBO-JJ 04/27/26

CBRE