



# POE·WEST

For the chance-takers and  
creators,  
the hard-workers and  
entrepreneurs,  
from food and fare to design and  
dreams.

556 PERRY AVENUE  
GREENVILLE, SC 29611



CBRE

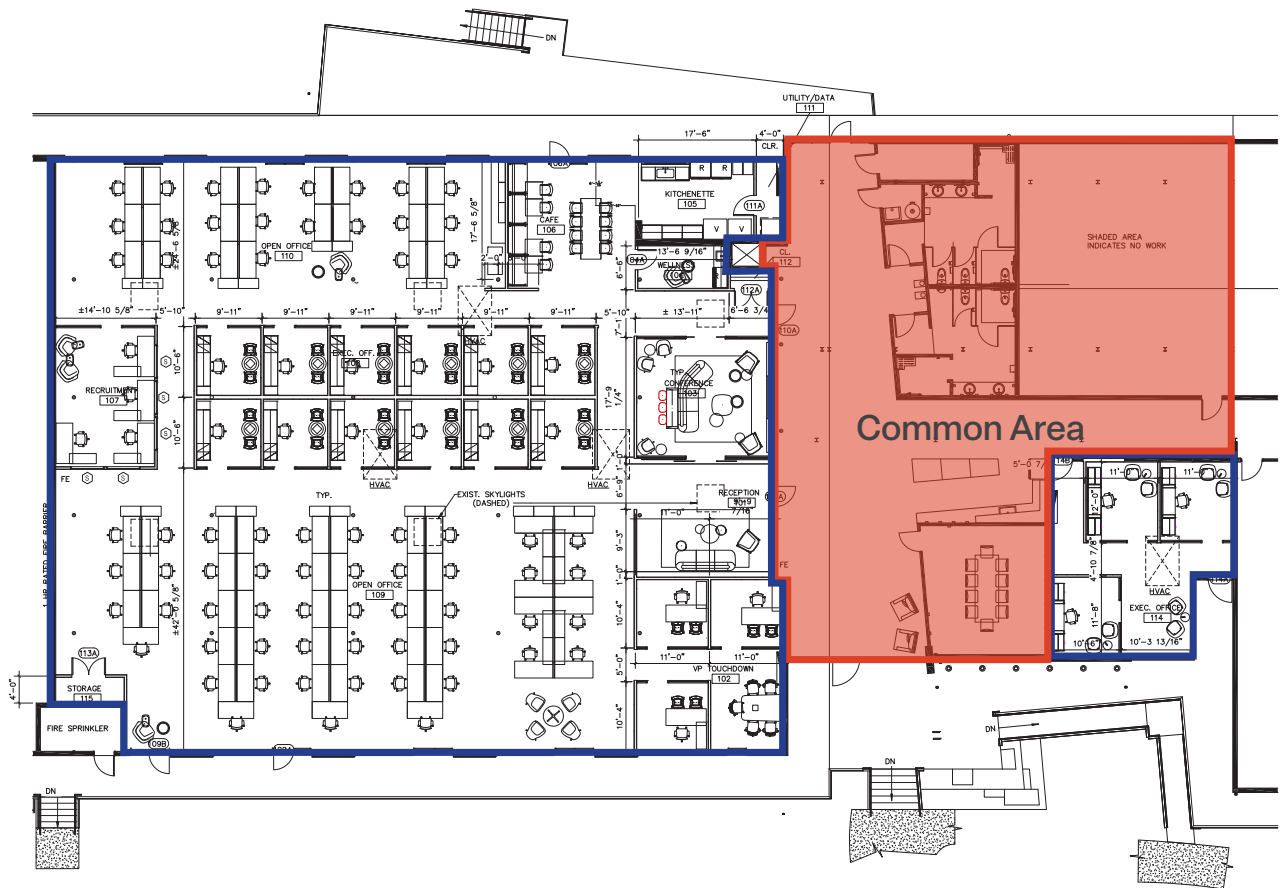

## Main Space.

- ±10,986 SF Available for Sublease through April 30, 2027
- Ability to sign direct lease with ownership
- Asking Rate, contact broker
- Free, on-site parking
- Fully Furnished with Brand New Systems
- Move in Ready with complete, first generation Class A office up fit occurring in 2020







# Join The West Village.



## The Arts.

- Art & Light
- Brains on Fire
- Greenville Center for Creative Arts
- Janina Tukarski Ellis
- Joseph Bradley Studio
- Kim Hassold
- The Art Bomb

## The Food.

- Anchorage
- Coastal Crust
- GB&D
- Kuka Juice
- The Rabbit Hole
- The Village Grind

## The Experience.

- Atlas Local
- Brandon Mill Lofts
- Community Journals
- Indigo Yoga
- Poe West
- Sixpense

## Contact.

Blaine Hart, SIOR  
 Senior Vice President  
 +1 864 527 6054  
 blaine.hart@cbre.com