

F O R L E A S E



**CBRE**

**1544** Eureka Road

R O S E V I L L E , C A

# PROPERTY HIGHLIGHTS

## SPACE AVAILABLE:

Suite 100 | ±2,103 RSF

Suite 120 | ±1,976 RSF

Suite 125 | ±5,693 RSF

Suite 130 | ±860 RSF

Suite 200 | ±5,386 RSF

Suite 260 | ±1,599 RSF

## LEASE RATE: \$2.35 PSF, Full Service Gross

- Prestigious Eureka Corporate Plaza address
- Amazing natural lighting
- First floor restrooms have lockers and showers

## NEARBY AMENITIES

Walk to some of Roseville's most popular Restaurants:

Fat's, Paul Martin's, Blue Nami, Sienna, Mikuni's Sushi, Bennett's Kitchen Bar  
Market, My Thai Kitchen, Beach Hut Deli, Panda Express

Local to Boutique and Regional Shopping and Services:

Stone Point Retail Center, Creekside Town Center, The Fountains Lifestyle  
Center, The Westfeld Galleria Mall

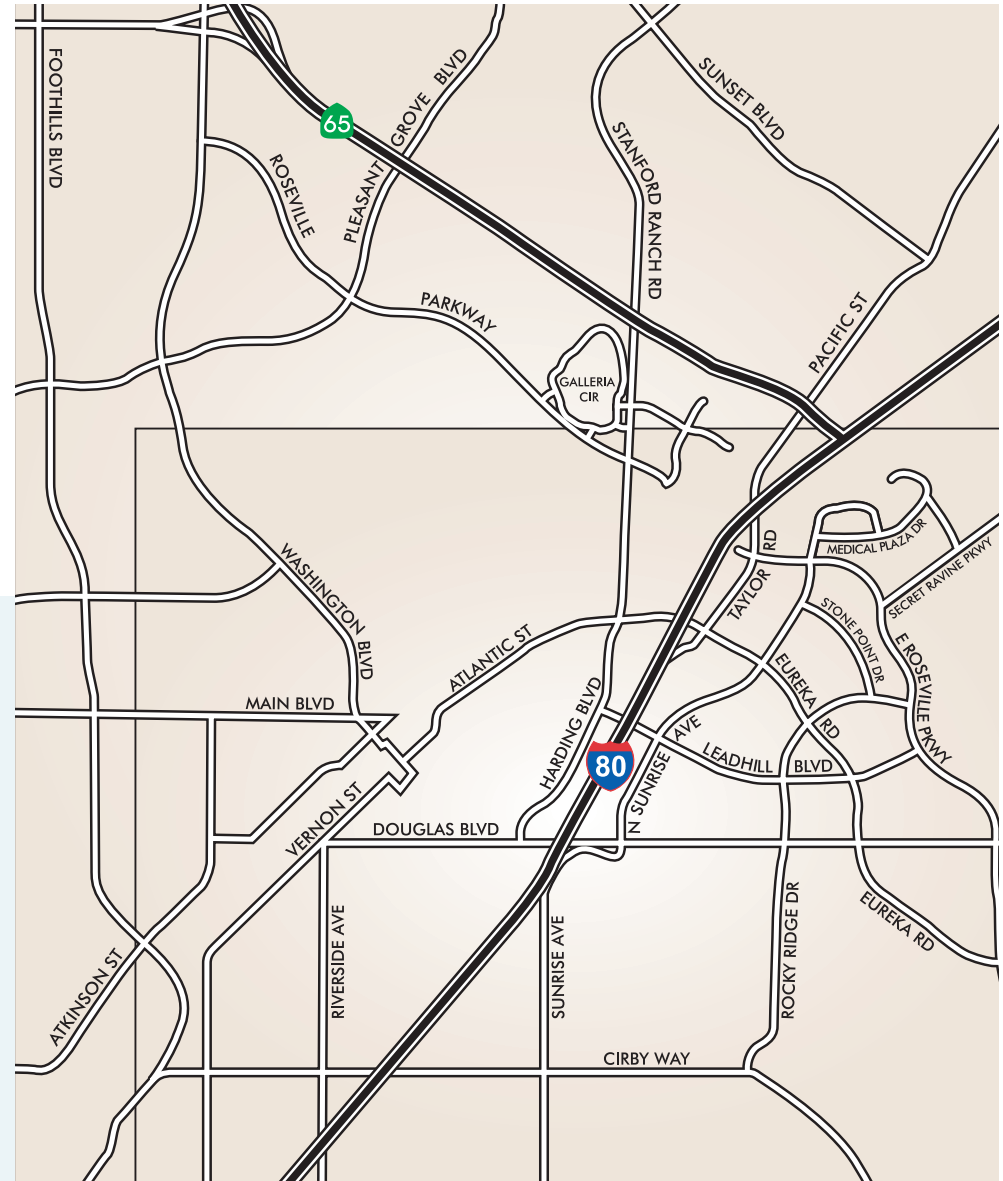

# FLOOR PLAN

## First Floor

\$2.35 PSF/Month, FSG



# FLOOR PLAN

## Second Floor

\$2.35 PSF/Month, FSG

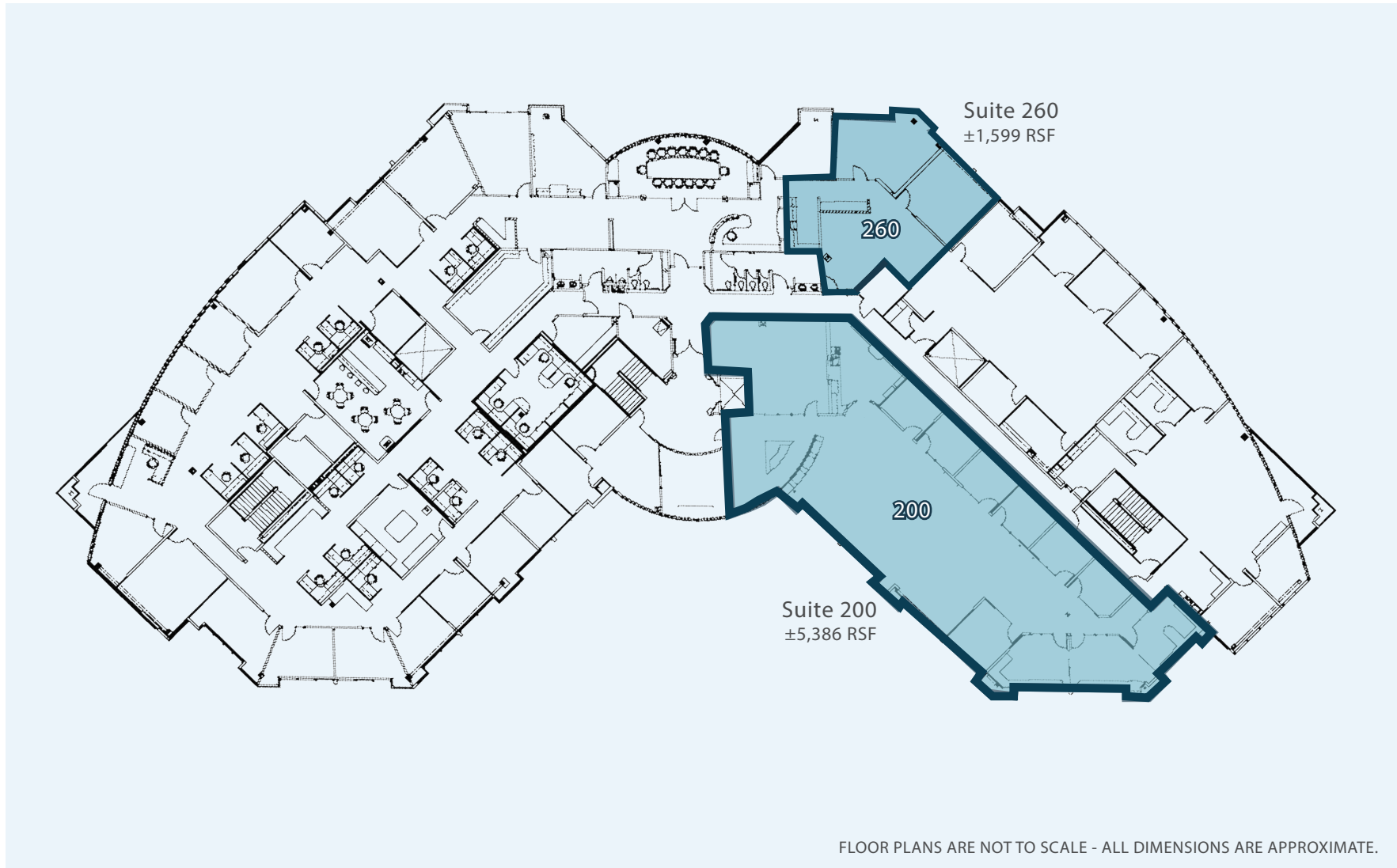

# AERIAL VIEW



1544 Eureka Road

1544  
Eureka Road



FOR MORE INFORMATION,  
CONTACT:

KEVIN LARSCHEID  
Executive Vice President  
+1 916 781 4818  
kevin.larscheid@cbre.com  
Lic. 00816790

SCOTT RUSH  
First Vice President  
+1 916 781 4802  
scott.rush@cbre.com  
Lic. 01228497

PHILLIP LARSCHEID  
Sales Associate  
+1 916 781 4848  
phillip.larscheid@cbre.com  
Lic. 02434984

© 2026 CBRE, Inc. All rights reserved. This information has been obtained from sources believed reliable but has not been verified for accuracy or completeness. You should conduct a careful, independent investigation of the property and verify all information. Any reliance on this information is solely at your own risk. CBRE and the CBRE logo are service marks of CBRE, Inc. All other marks displayed on this document are the property of their respective owners, and the use of such logos does not imply any affiliation with or endorsement of CBRE. Photos herein are the property of their respective owners. Use of these images without the express written consent of the owner is prohibited. CPM Eureka Rd, 1544 Final 04/07/26

CBRE