

2070-2074 Farallon Drive
San Leandro, CA 94577
www.cbre.com

2070-2074 Farallon Drive

Freestanding manufacturing/warehouse building of ±15,060 square feet situated on ±.97 acre parcel of land. Divisible into two separate units of 10,360 SF and 4,700 SF.

AVAILABLE NOW



Property Highlights

- + Two separate office areas of ±4,500sf & 1,100 sf
- + 3 Dock highdoors
- + 3 Grade level doors
- + 17' Clear height
- + Large fenced and paved yard area
- + Excellent street identity
- + Well landscaped building



Prime East Bay Industrial Location

2070-2074 Farallon Drive is part of a well-established industrial pocket with strong regional connectivity and proximity to major Bay Area infrastructure.

- Immediate access to Interstate 880, with connectivity to Interstate 238 and Interstate 580
- ±10–15 minutes to Oakland International Airport
- ±15–20 minutes to Port of Oakland, a major West Coast logistics hub
- Near San Leandro BART Station providing regional transit access
- Centrally located between Oakland and Hayward
- Approx. 30–40 minutes to San Francisco
- Proximity to key industrial corridors including Davis St and Marina Blvd
- Strong access to East Bay labor pool and dense population base

SITE PLAN



FLOOR PLAN

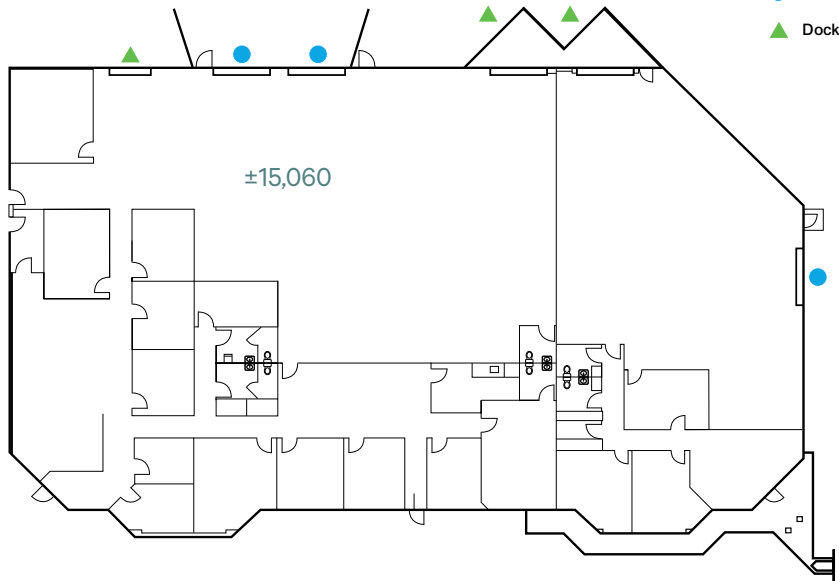

Contact Us

Kenneth D. Morris

First Vice President
+1 510 219 0319
ken.morris@cbre.com
Lic. 01312918

Michael Barry

Executive Vice President
+1 510 908 2817
michael.barry@cbre.com
Lic. 00950054

