

FOR SUBLEASE

SOJO

STATION SOUTH

10377 S JORDAN GATEWAY
SOUTH JORDAN, UT

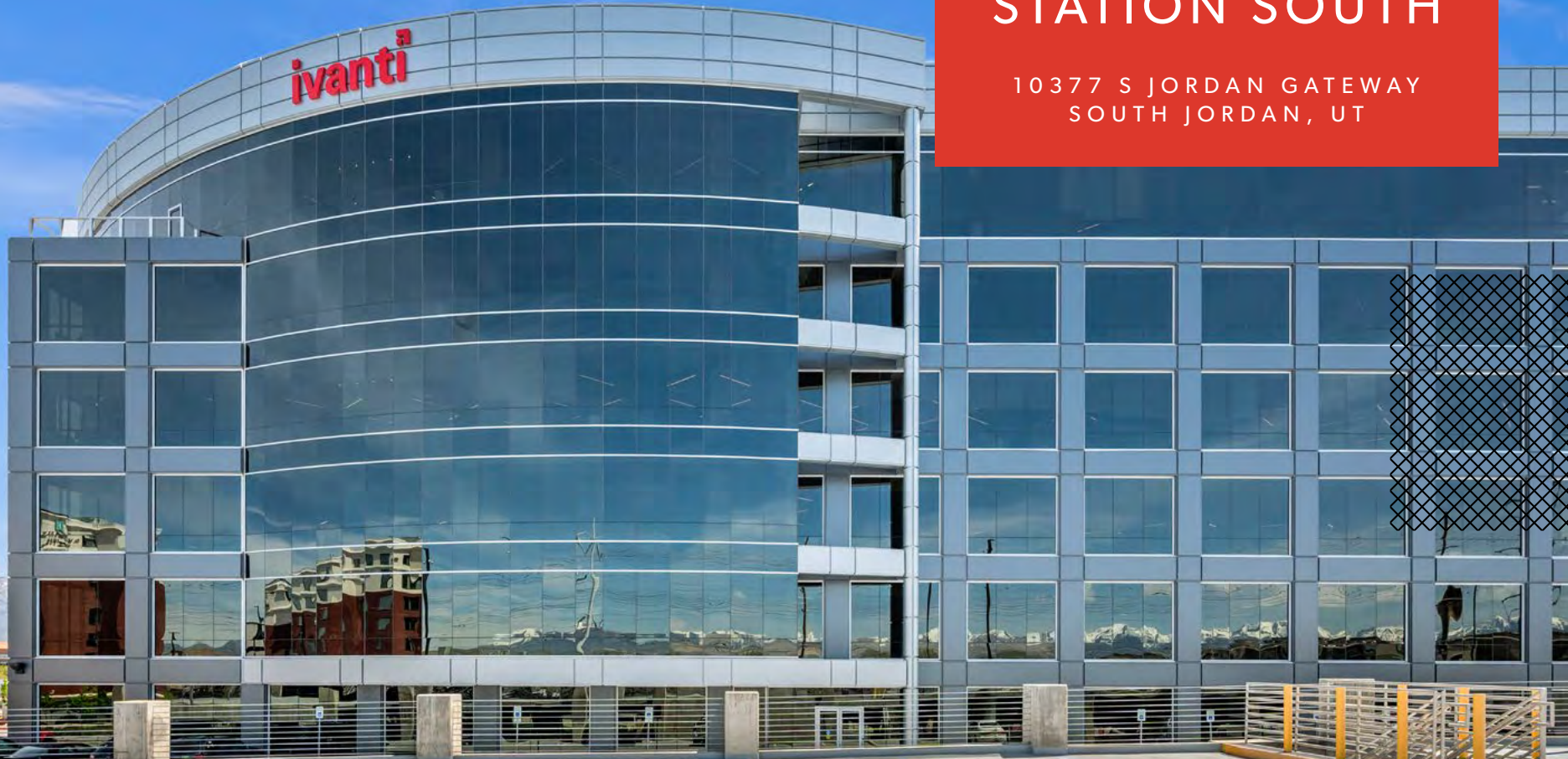

CBRE

SOJO STATION SOUTH

10377 S JORDAN GATEWAY
SOUTH JORDAN, UT

PROPERTY SPECIFICATIONS

- Up to 62,620 rentable square feet available
- \$32.00/RSF, Full Service Gross
- Available October 1, 2026
- Master Lease through February 28, 2033
- Plug and play condition, brand new space, high-tech build-out
- Signage rights for a two-floor user
- 4.5/1,000 USF parking ratio, structured parking
- Direct access to South Jordan FrontRunner Station
- 2-minute drive to freeway access
- Floor-to-ceiling glass



AMENITIES



FITNESS CENTER
Employee Fitness Center
with lockers and showers



BIKE ROOM
Enclosed bike
storage room



EV CHARGING STATIONS
8 EV Charging Stations



TRANSPORTATION
Immediate access to South
Jordan FrontRunner station



FREEWAY ACCESS
Direct access to 10600
South Freeway Ramp



UNEMCUMBERED VIEWS
Magestic views of the Wasatch
Front mountains and valley



5TH FLOOR UP TO 31,413 RSF AVAILABLE

FLOOR PLANS

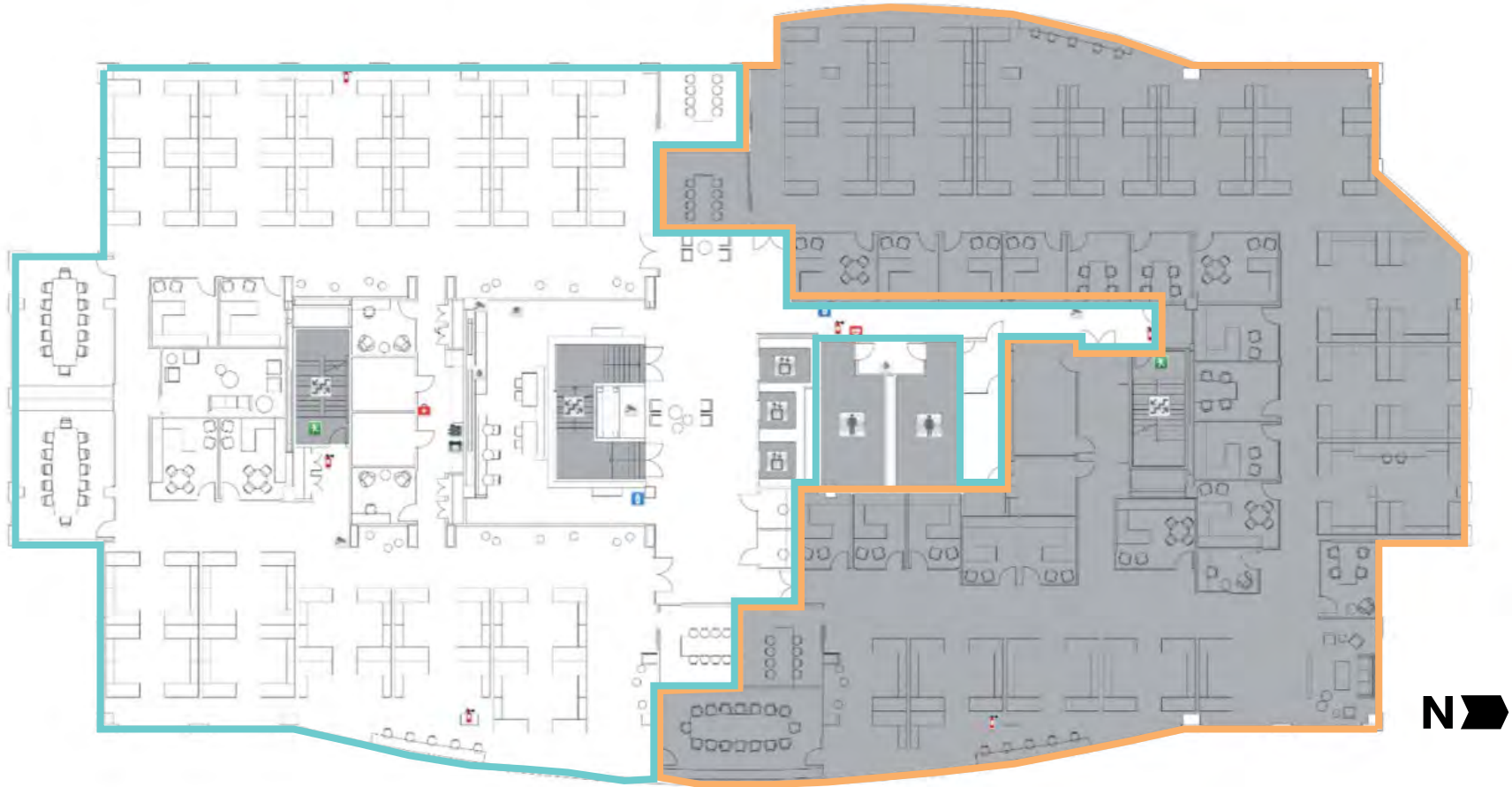

5th Floor - South Side Furniture 14,774 RSF

- 5 Offices
- 2 Focus Rooms
- 4 Meeting Rooms
- 80 Desks

5th Floor - North Side Furniture 16,639 RSF

- 14 Offices
- 1 Focus Rooms
- 7 Meeting Rooms
- 80 Desks

6TH FLOOR 31,207 RSF AVAILABLE

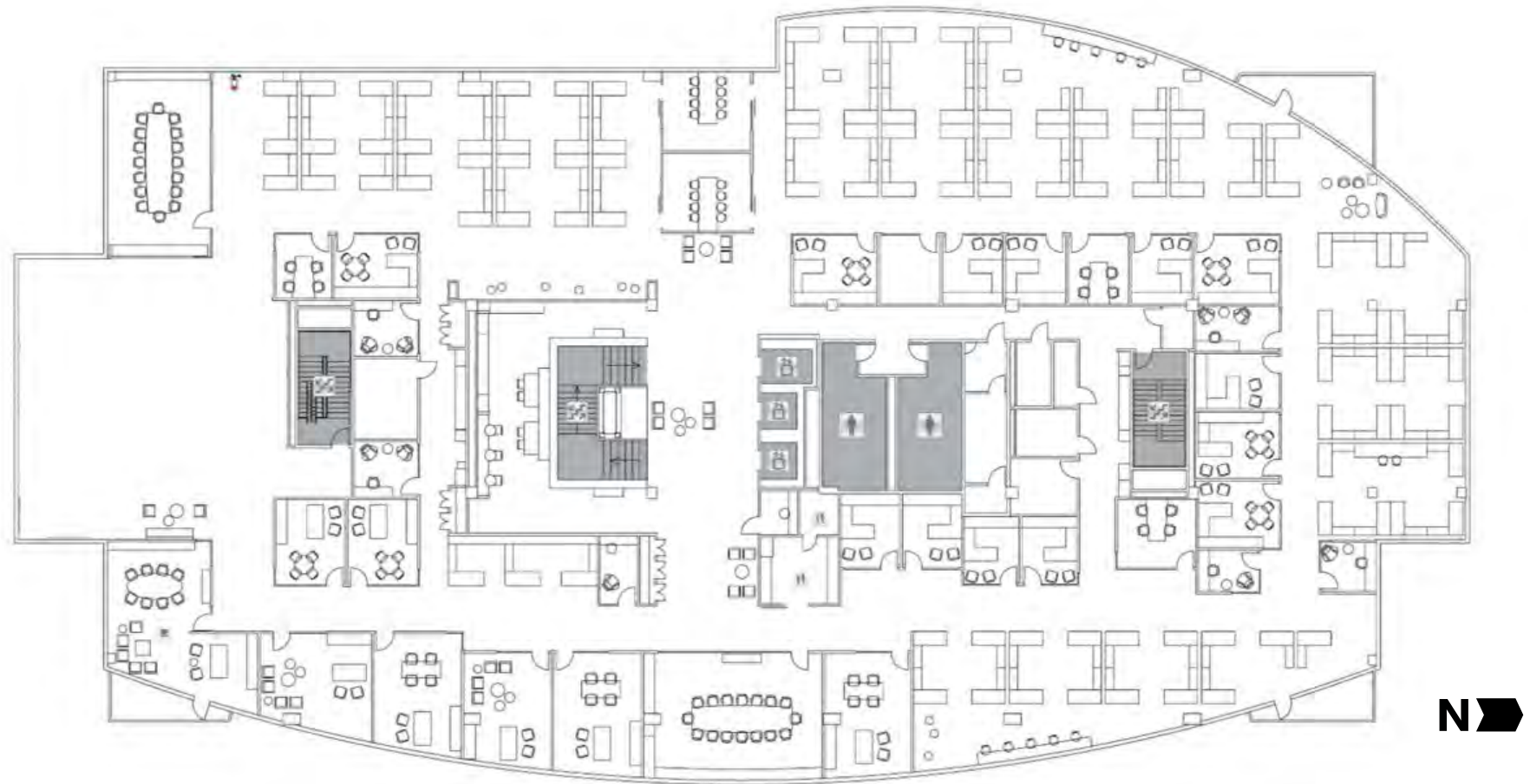

6th Floor Furniture

- 27 Offices
- 5 Focus Rooms
- 7 Meeting Rooms
- 106 Desks

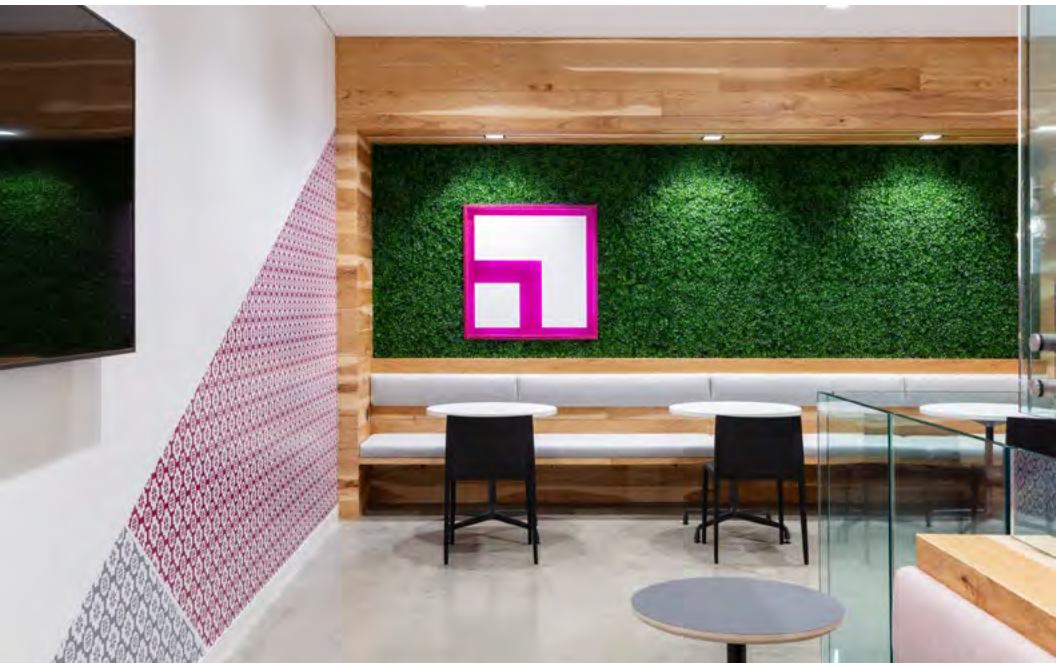

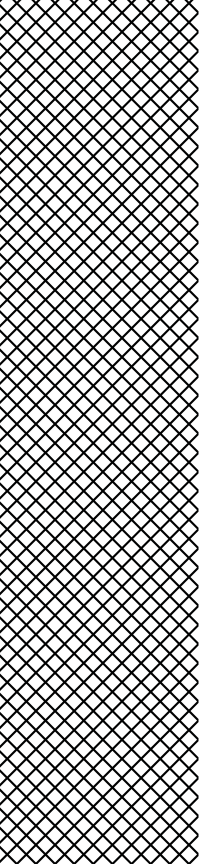

The Shops at South Town

- ★ Macy's
- ★ JC Penney
- ★ H and M
- ★ Home Goods
- ★ Buckle
- ★ The Children's Place
- ★ Tommy Hilfiger
- ★ New York and Company
- ★ Hollister
- ★ Victoria's Secret
- ★ Forever 21
- ★ Childrens Place
- ★ Aéropostale
- ★ PacSun
- ★ American Eagle Outfitters
- ★ maurices
- ★ Torrid
- ★ Hot Topic
- ★ Zumiez
- ★ Christopher and Banks
- ★ Aerie
- ★ Journeys
- ★ Sunglass Hut
- ★ Motherhood Maternity
- ★ Lids
- ★ Famous Footwear
- ★ LensCrafters
- ★ Foot Locker
- ★ Charley's
- ★ GNC
- ★ Sephora
- ★ Finish Line

Food

- | | |
|---------------------------|---------------------------|
| 1 Gecko's Mexican Grill | 14 Jamba Juice |
| 2 Barbacoa | 15 Simply Thai |
| 3 JCW's | 16 Subway |
| 4 Bawarchi | 17 Krispy Kreme Doughnuts |
| 5 Subway | 18 El Pollo Loco |
| 6 Beans & Brews | 19 Olive Garden |
| 7 R&R BBQ | 20 Mimi's Cafe |
| 8 Texas Roadhouse | 21 Chili's Grill and Bar |
| 9 Potbelly Sandwich Works | 22 Noodles and Company |
| 10 Starbucks US | 23 Pizza Hut |
| 11 Jims | 24 Chick-fil-A |
| 12 Legends Pub & Grill | 25 Starbucks US |
| 13 Wendy's | |

Shopping

- 1 CVS
- 2 Target
- 3 Barnes and Noble
- 4 Old Navy
- 5 Buy Buy Baby
- 6 REI
- 7 Ethan Allen

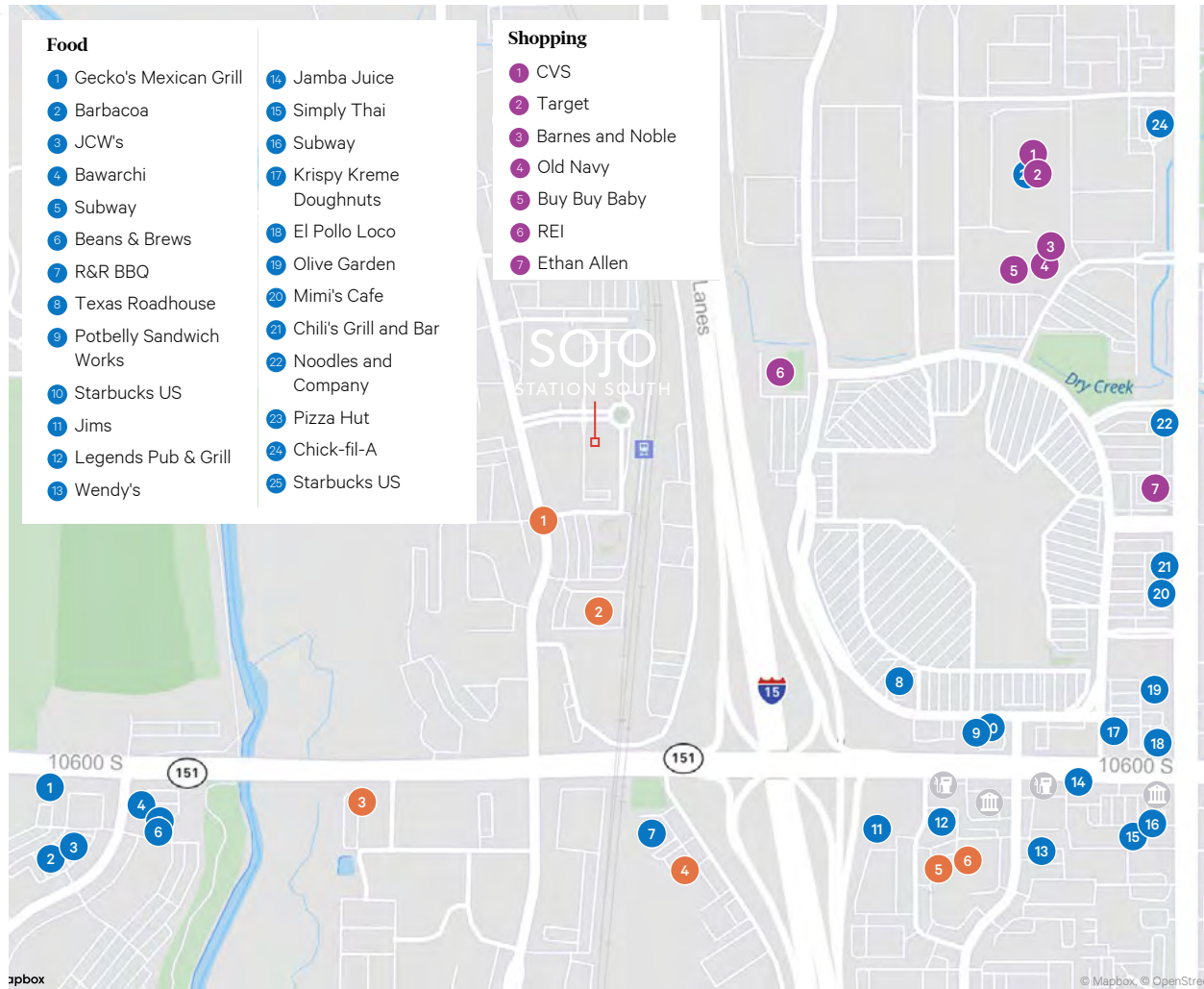

- Spencer's
- Zumiez
- Sprint
- Shoe Show
- Bath and Body Works
- Icing

- Payless
- Hallmark Cards
- Things Remembered
- Kay Jewelers
- Morgan Jewelers
- Spring Mobile

- AT and T Store
- T-Mobile
- Round One
- Entertainment
- Hickory Farms
- Greek Kabob

- Sampan Asian Cuisine
- Panda Express
- Subway
- Pretzelmaker
- Mrs. Fields
- Hot Dog on a Stick

Hotels

- | | |
|-----------------------------|-------------------------|
| 1 Embassy Suites Hotels | 4 Sleep Inn |
| 2 Holiday Inn | 5 Courtyard by Marriott |
| 3 La Quinta Inns and Suites | 6 Holiday Inn Express |
| 4 Sleep Inn | |

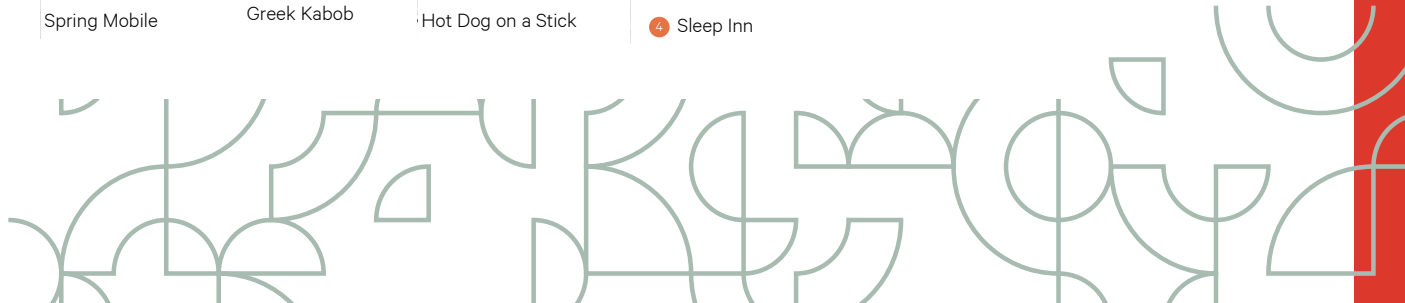

sojo

STATION SOUTH

10377 S JORDAN GATEWAY
SOUTH JORDAN, UT



CONTACT US

NADIA LETEY

Senior Vice President
+1801 869 8055
nadia.letey@cbre.com

©2026 CBRE, Inc. All rights reserved. This information has been obtained from sources believed reliable but has not been verified for accuracy or completeness. CBRE, Inc. makes no guarantee, representation or warranty and accepts no responsibility or liability as to the accuracy, completeness, or reliability of the information contained herein. You should conduct a careful, independent investigation of the property and verify all information. Any reliance on this information is solely at your own risk.

CBRE