

Office | For Sublease

**CBRE**

# 170 South Main Street

3,831 RSF Available

170 South Main Street, Ste 800B & 875  
Salt Lake City, UT  
[www.cbre.com/slc](http://www.cbre.com/slc)



170 South Main Street, Ste 800B & 875

Salt Lake City, UT

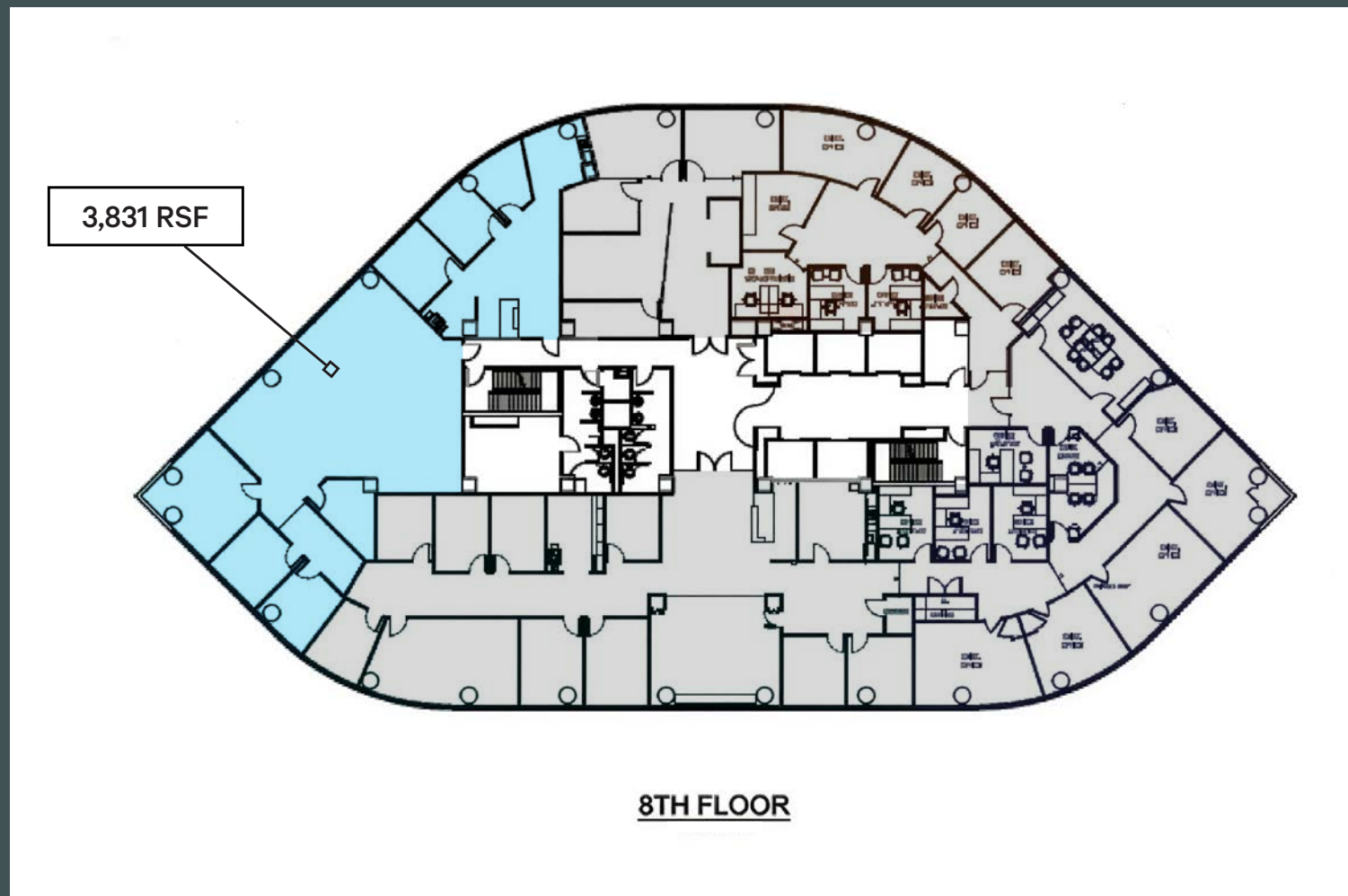

## Property Specifications

- + \$28.00 / RSF, Full Service Gross
- + 3,831 RSF
- + 8th Floor with views of downtown
- + Available Now
- + Sublease expires May 31, 2027
- + Furniture Available
- + Access to the buildings conference room, training room, tenant lounge, library, and fitness center
- + On-site property management
- + Prime location in the CBD in close proximity to dining, shopping, and entertainment
- + 24-hour security
- + Three distinct on-property restaurant options
- + Secured bike storage
- + Excellent TRAX and bus route accessibility

For Sublease



