

Industrial | For Lease

CBRE

8001 W 47th St, Lyons, IL

OWNED BY:
REALTERM

±19,553 - 60,577 SF AVAILABLE WITH UP TO 2 ACRES OF SECURED YARD SPACE



8001 W 47th St

8001 W 47th St | Lyons, IL 60534

For Lease

Unit A Overview

BUILDING SPECIFICATIONS

Total Available SF	±41,024 SF (Expandable to ±60,577 SF)
Office SF	±5,462 SF
Clear Height	14'6" - 18'
Loading Docks	2 exterior docks
Drive In Doors	2 (14' high) Expandable
Column Spacing	49'4" x 26"
Parking	±40 car parking & up to ±2 acres
Date Available	ASAP
Asking Lease Rate	Subject to offer

PROPERTY HIGHLIGHTS

- Excellent tractor repair, warehousing or light manufacturing facility
- Fully sprinklered
- Easy access to I-55 via full interchange at 1st Ave
- Strong surrounding labor pool
- Variety of amenities available in the near area
- Drive in capability



Unit A Floor Plan

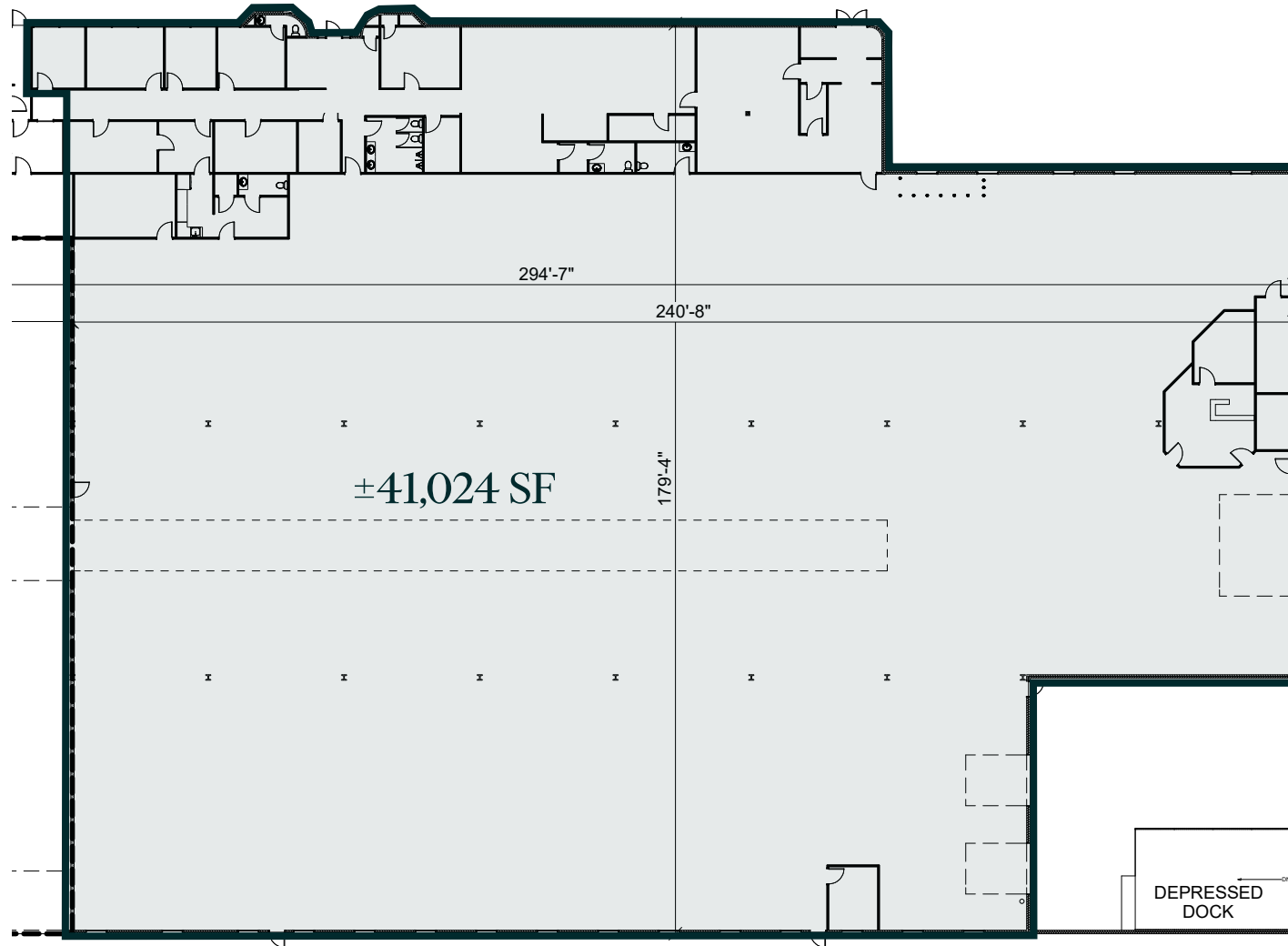

8001 W 47th St

8001 W 47th St | Lyons, IL 60534

For Lease

Unit B Overview

BUILDING SPECIFICATIONS

Total Available SF	±19,553 SF (Expandable to 60,577 SF)
Office SF	±2,106 SF
Clear Height	14'6" - 18'
Drive In Doors	5 (14' high)
Column Spacing	49'4" x 26"
Parking	±10 car parking & up to ±1.00 acre
Date Available	June 1, 2026

PROPERTY HIGHLIGHTS

Recent renovations include new LED lighting, new paint in the warehouse, new warehouse heaters, renovated office space, and renovated restrooms

Strong surrounding labor pool

Ample parking

Drive in capability

Fully sprinklered

Easy access to I-55 via full interchange at 1st Avenue

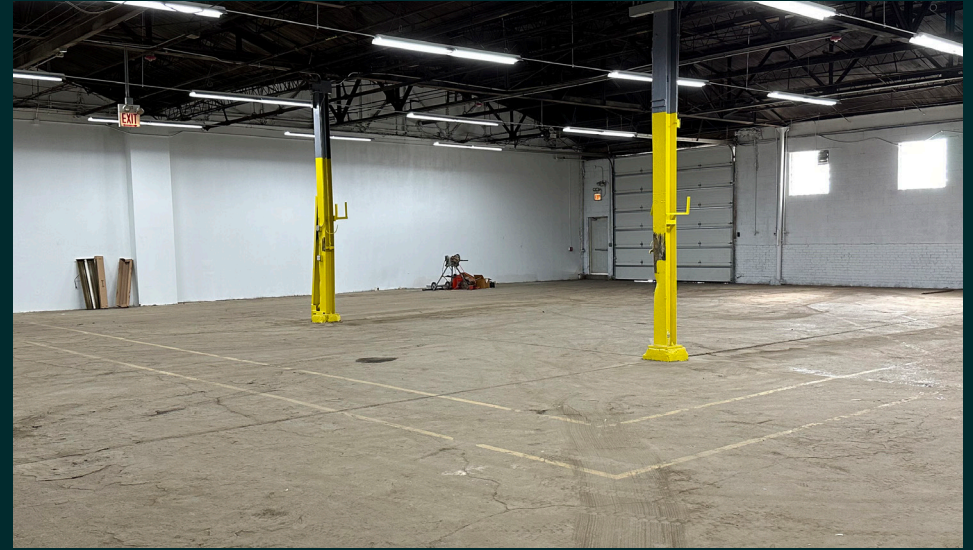

8001 W 47th St

8001 W 47th St | Lyons, IL 60534

For Lease

Unit B Floorplan

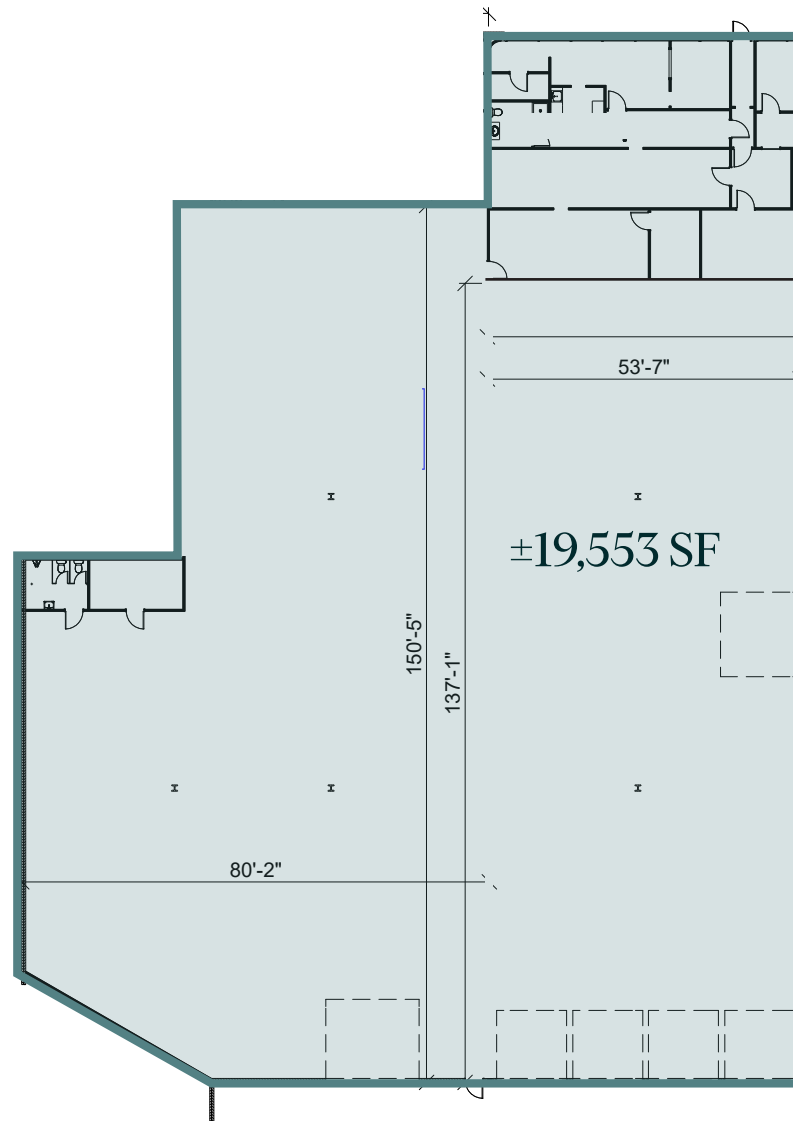

8001 W 47th St
8001 W 47th St | Lyons, IL 60534

For Lease

Access & Area Overview



8001 W 47th St
8001 W 47th St | Lyons, IL 60534

For Lease

Corporate Neighbors



8001 W 47th St

8001 W 47th St | Lyons, IL 60534

For Lease



Larry Goldwasser, SIOR

Executive Vice President

+1 314 334 7201

larry.goldwasser@cbre.com

Colin Green, SIOR

Senior Vice President

+1 314 334 7202

colin.s.green@cbre.com

John Marks

Vice President

+1 314 334 7204

john.marks@cbre.com

CBRE

OWNED BY:
REALTERM

© 2026 CBRE, Inc. All rights reserved. This information has been obtained from sources believed reliable, but has not been verified for accuracy or completeness. You should conduct a careful, independent investigation of the property and verify all information. Any reliance on this information is solely at your own risk. CBRE and the CBRE logo are service marks of CBRE, Inc. All other marks displayed on this document are the property of their respective owners, and the use of such logos does not imply any affiliation with or endorsement of CBRE. Photos herein are the property of their respective owners. Use of these images without the express written consent of the owner is prohibited.