

**±5,621 SF
FOR LEASE**



7300 CENTRAL AVENUE
NEWARK, CA

**7300 CENTRAL
AVENUE**

CBRE

PROPERTY OVERVIEW

Highlights

- » Suite D ±5,621 SF
 - One Grade Level Door
- » HVAC Office
- » 18' Clear Height
- » 2.5/1,000 Parking
- » High Image Corner Location
- » Reverse Commute
- » Minutes from Dumbarton Bridge/Menlo Park

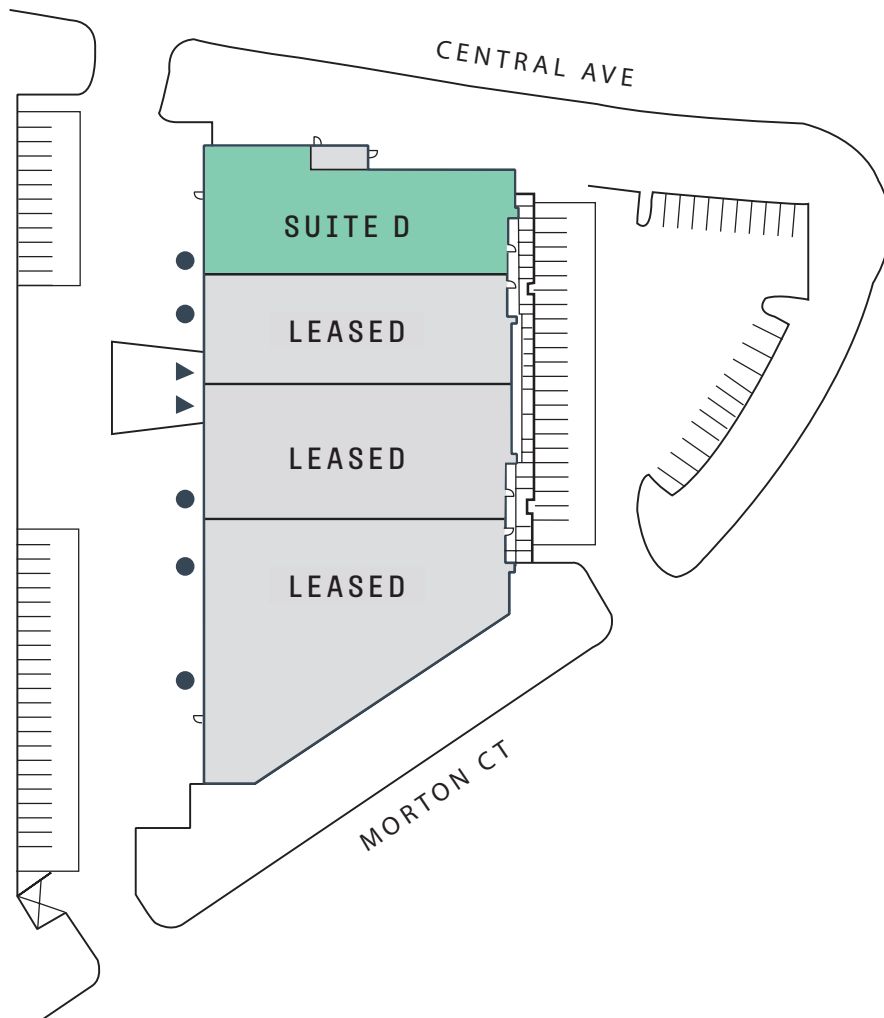

▶ Dock High ● Grade Level



FLOOR PLAN

7300 Central Avenue, Suite D

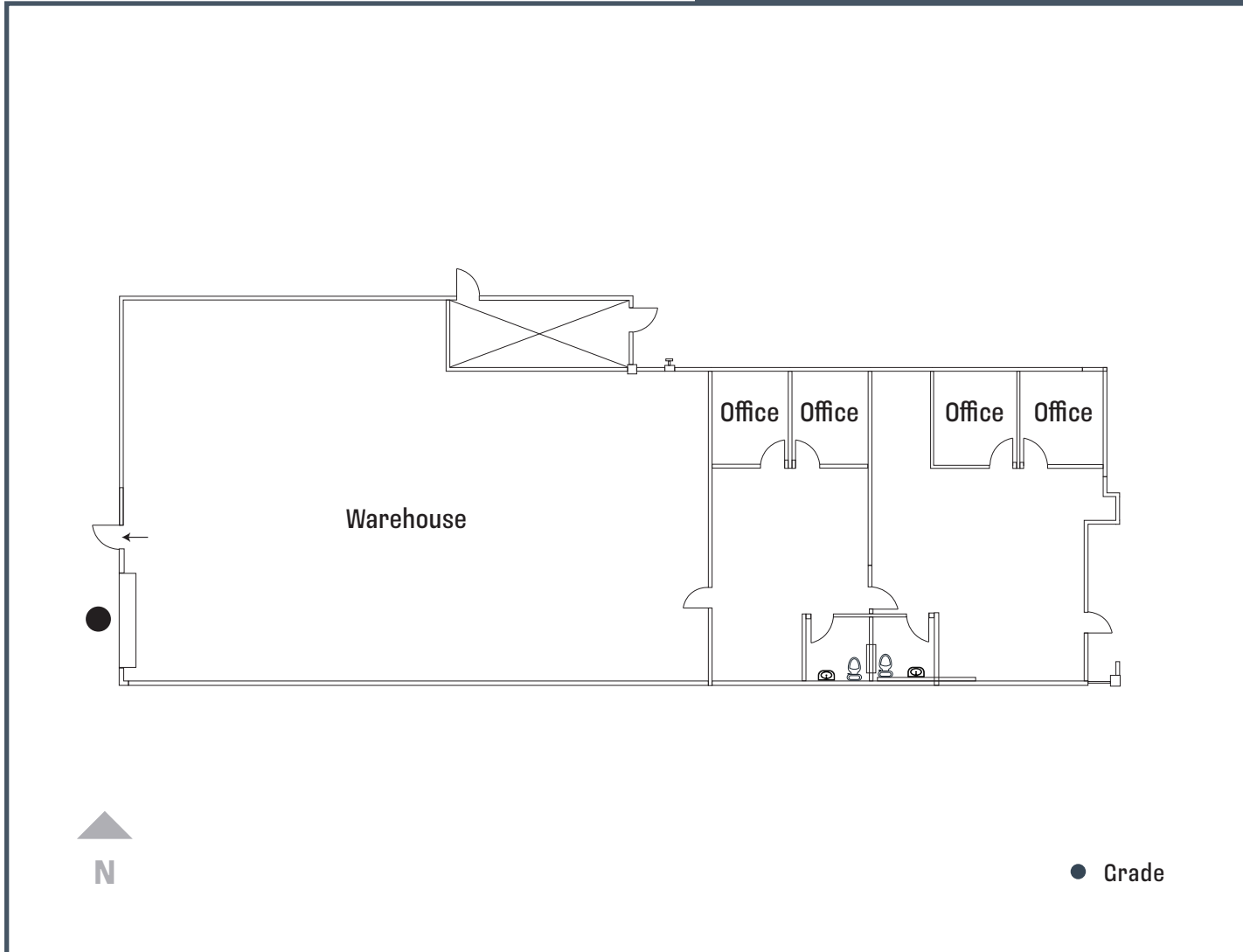

±5,621 SF

4
Private Offices

Open
Office

2
Restrooms

1
Grade Level Door

End
Unit

Available
Spring 2026

CORPORATE NEIGHBORS



TRANSIT MAP

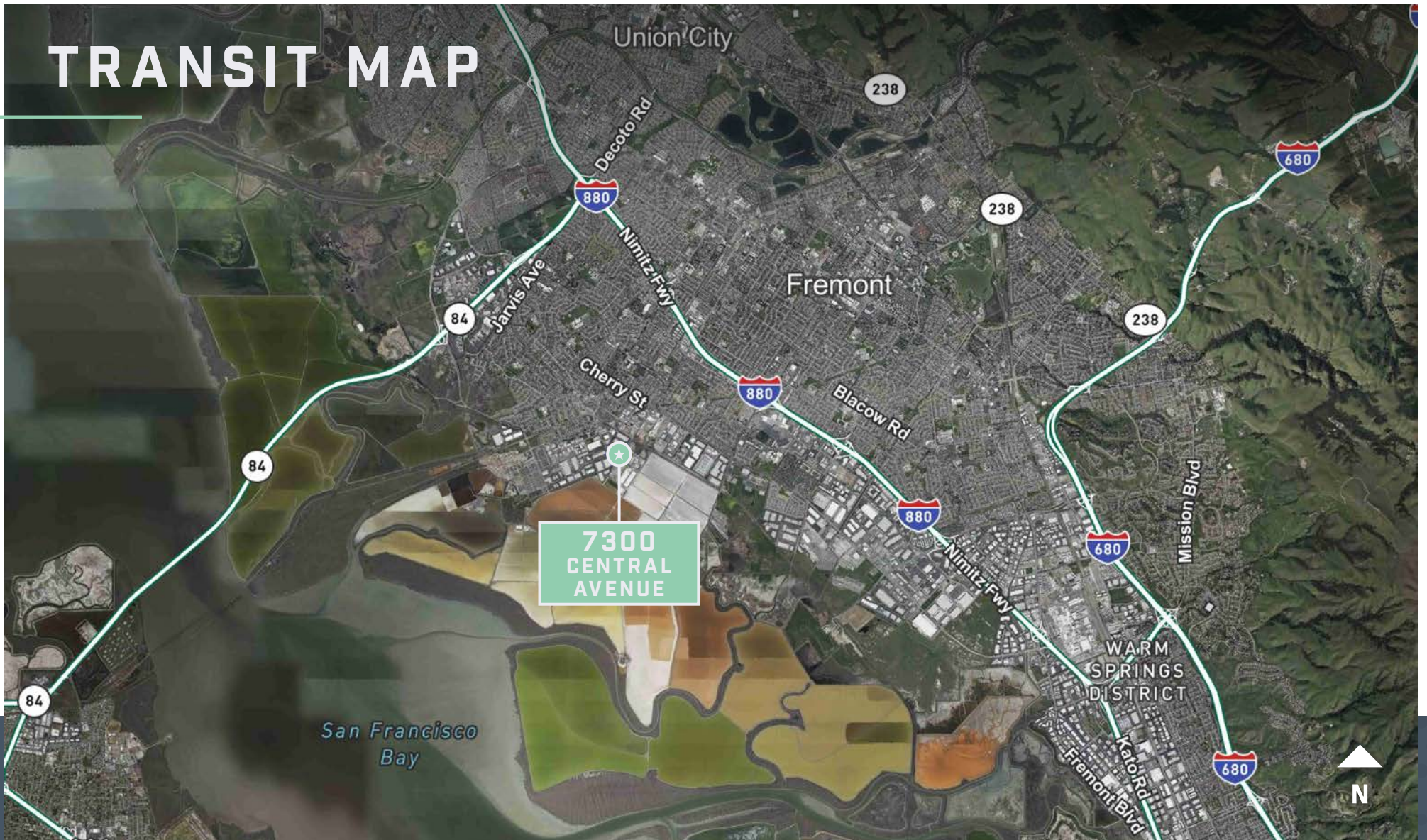

HIGHLIGHTS



±2.2 Miles

from I-880 &
Thornton Avenue



±3.2 Miles

to Hwy 84/
Dumbarton Bridge



**7300
CENTRAL AVENUE
NEWARK, CA**

7300 CENTRAL AVENUE

**±5,621 SF
FOR LEASE**

CHIP SUTHERLAND

Vice Chairman
+1 408 453 7410
chip.sutherland@cbre.com
Lic. 01014633

LISA WALSH STUDER

Transaction Manager
+1 408 467 7530
lisa.studer@cbre.com
Lic. 01264320

CBRE

© 2026 CBRE, Inc. All rights reserved. This information has been obtained from sources believed reliable but has not been verified for accuracy or completeness. CBRE, Inc. makes no guarantee, representation or warranty and accepts no responsibility or liability as to the accuracy, completeness, or reliability of the information contained herein. You should conduct a careful, independent investigation of the property and verify all information. Any reliance on this information is solely at your own risk. CBRE and the CBRE logo are service marks of CBRE, Inc. All other marks displayed on this document are the property of their respective owners, and the use of such marks does not imply any affiliation with or endorsement of CBRE. Photos herein are the property of their respective owners. Use of these images without the express written consent of the owner is prohibited.