



WILLIMON
BUSINESS PARK

Building D

880 Antioch Church Road, Greenville, SC 29605



126,360 SF AVAILABLE - FOR LEASE

Contact Broker for Pricing

CBRE

Collett
INDUSTRIAL



GTIS PARTNERS

Site Plan



Building D Floor Plan

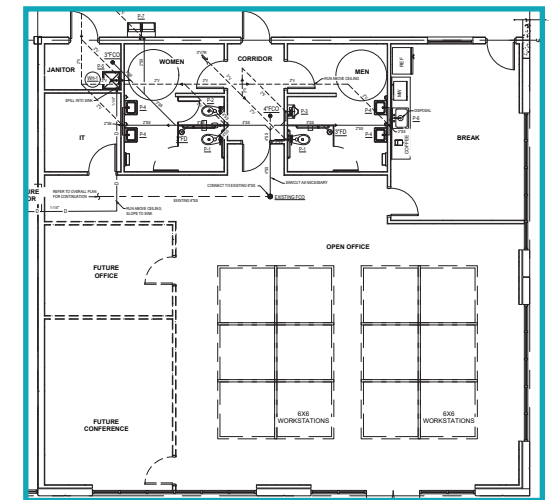
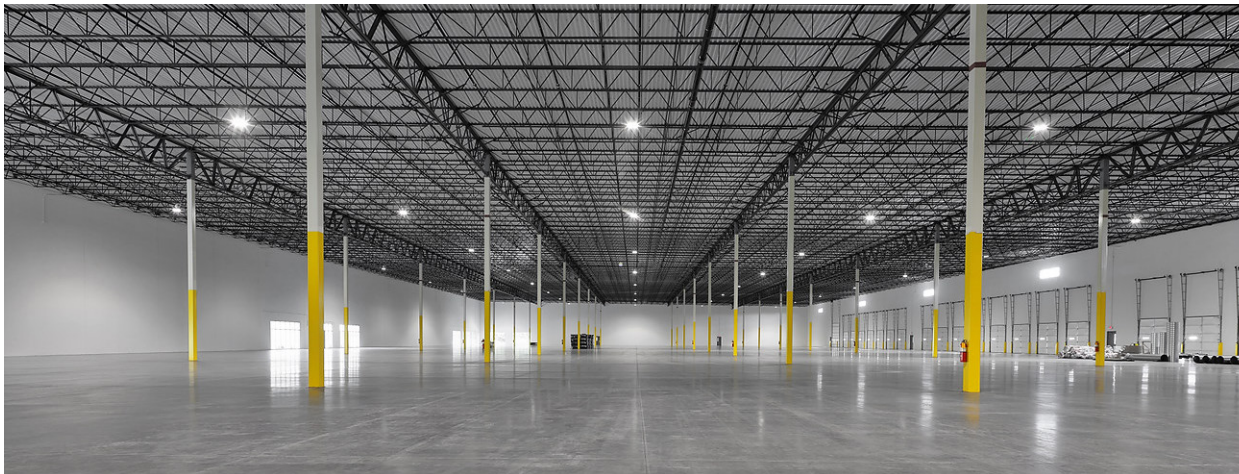
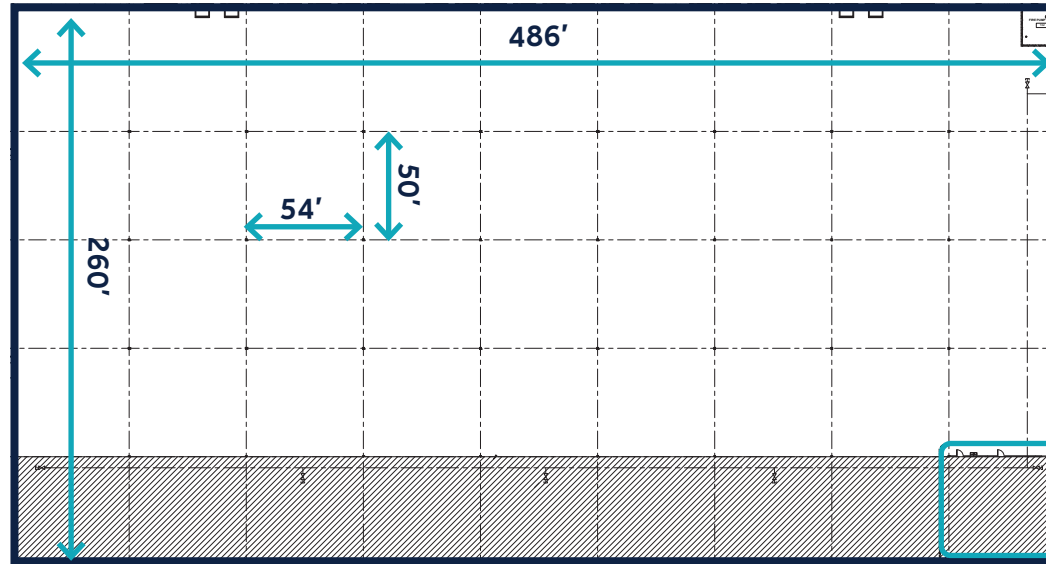

Building D Details



Building Size: ±126,360 SF



Spec Office: ±2,640 SF

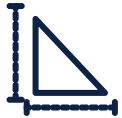

Building Dimensions: 260' x 486'



Column Spacing: 50' x 54'
(60' Speed Bay)



Clear Height: 32'



Dock Doors: 18 (9' x 10')



Dock Packages: 4 (Blue Giant)



Drive-In Doors: 2 (14' x 16')



Flooring: 6", 4000 psi



Fire Protection: ESFR



Lighting: 10 FC, LED, 36K lumens,
motion sensor, one fixture per bay



Auto Parking: 100



Trailer Parking: 29



Roof: TPO, Single Ply Membrane, 45
MIL TPO, R-20



Truck Court: 185'



Power: 2000 amps

Building D Divisibility

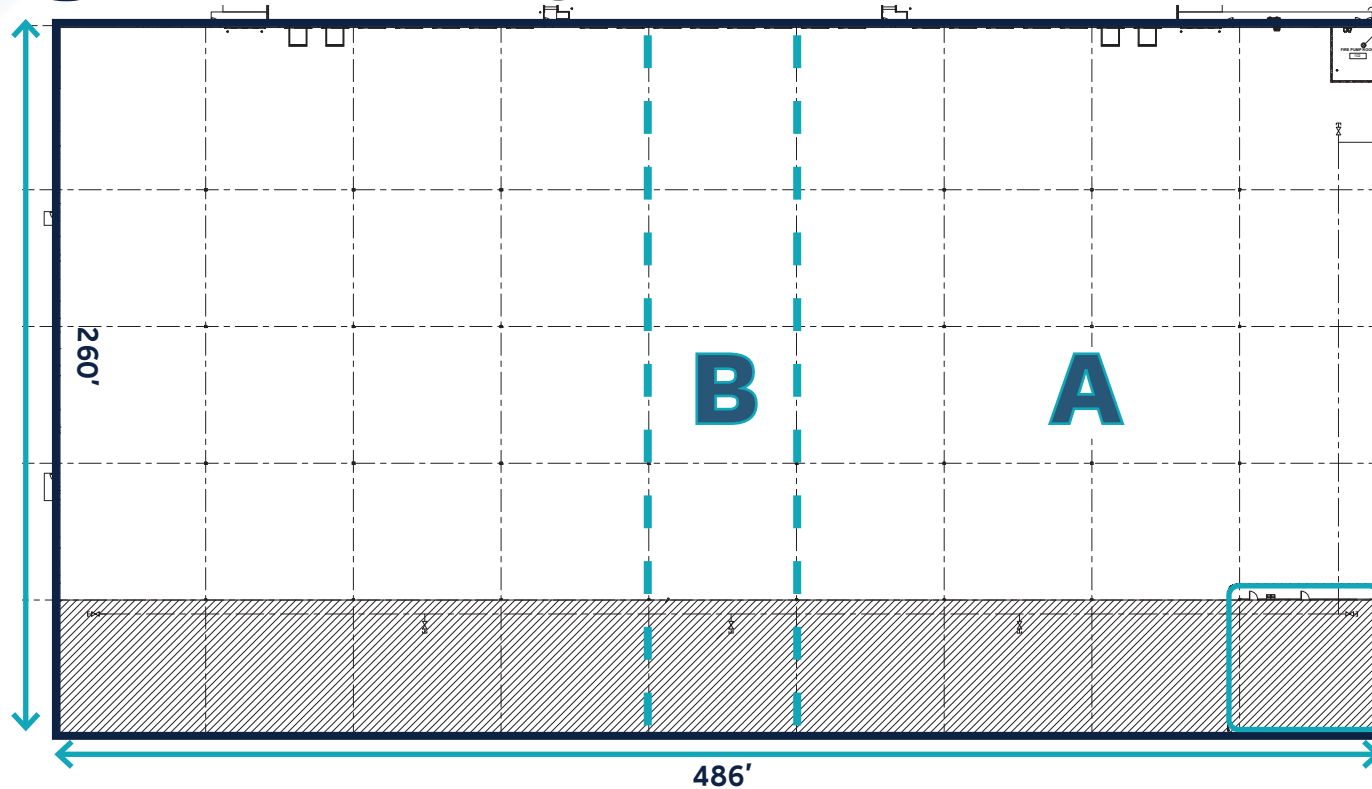

| Option A | Option B | Full Building |
|--------------------------|--------------------------|--------------------------|
| Size: ±56,160 SF | Size: ±70,200 SF | Size: ±126,360 SF |
| Bays: 4 | Bays: 5 | Bays: 9 |
| Dock Doors: 9 | Dock Doors: 13 | Dock Doors: 18 |
| Drive-In Doors: 1 | Drive-In Doors: 1 | Drive-In Doors: 2 |

Surrounding Tenants

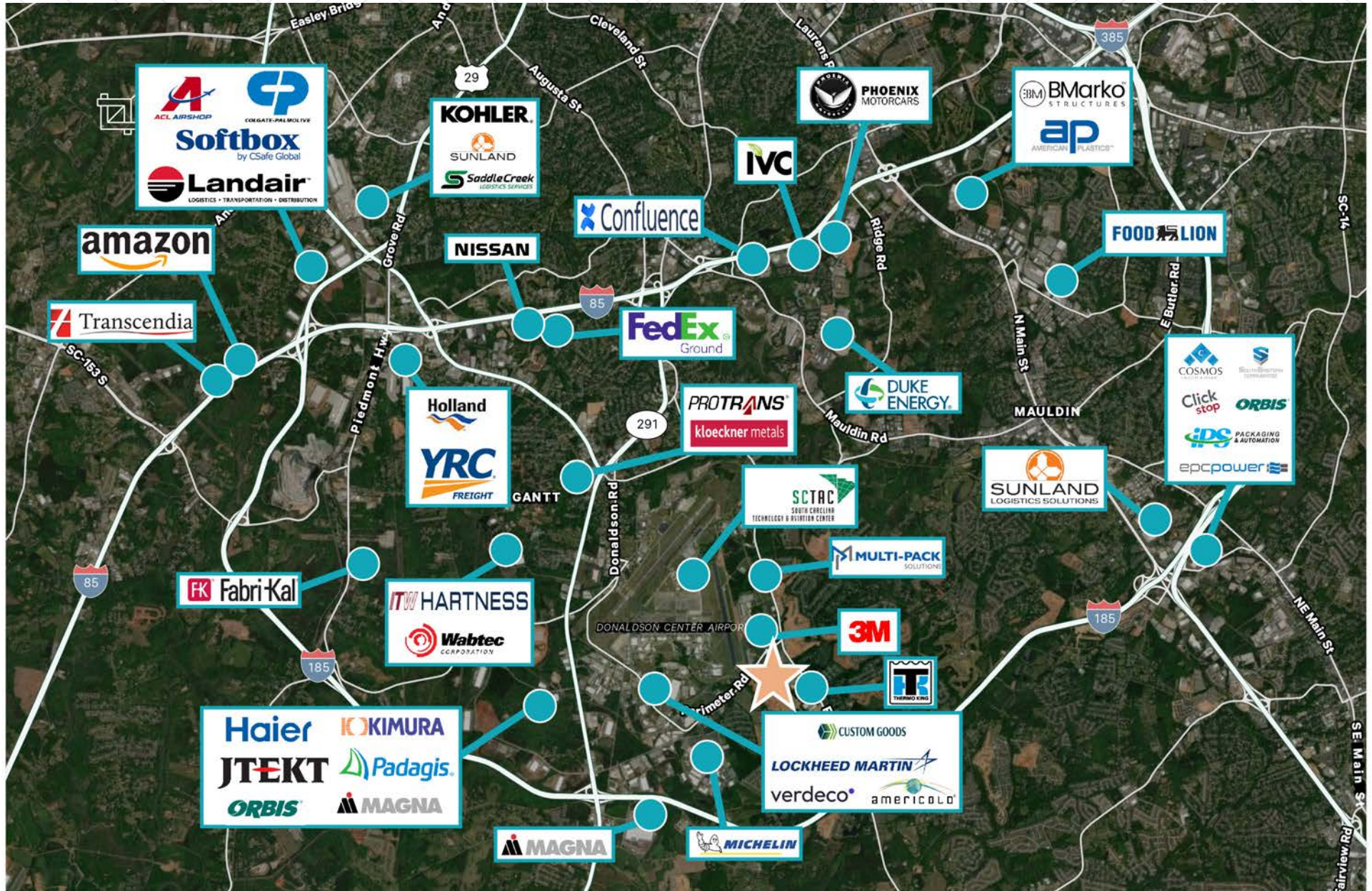

Labor & Demographics

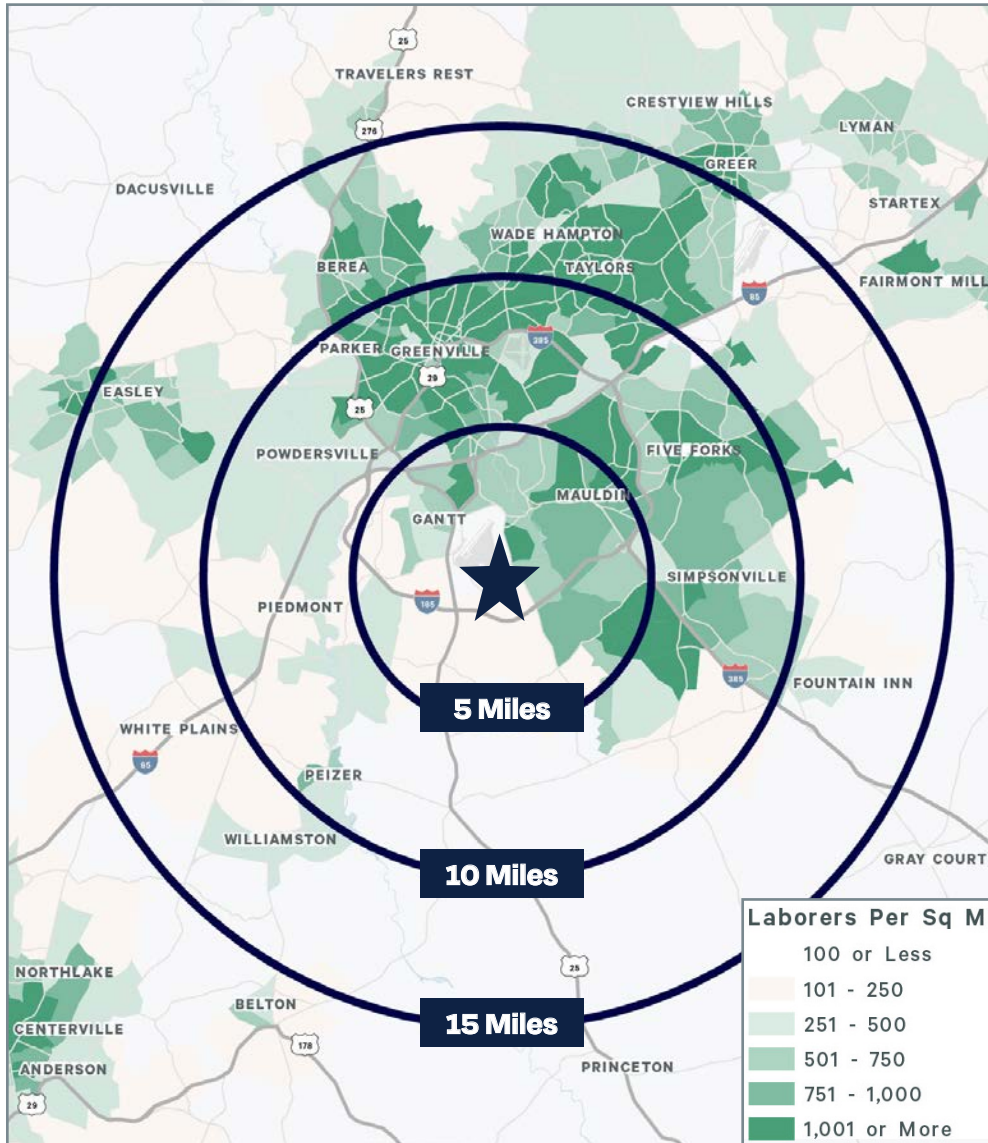

| LOCATION | DISTANCE |
|---------------------|------------|
| Donaldson Airport | 0.1 Miles |
| I-185 | 2.0 Miles |
| I-385 | 6.2 Miles |
| I-85 | 7.0 Miles |
| Downtown Greenville | 8.4 Miles |
| GSP Airport | 16.8 Miles |

| | 5 MILES | 10 MILES | 15 MILES |
|-----------------------------|----------|-----------|-----------|
| POPULATION | 80,047 | 363,550 | 302,349 |
| DAYTIME POPULATION | 78,063 | 426,144 | 642,972 |
| BUSINESSES | 2,216 | 16,601 | 22,620 |
| LABOR FORCE | 41,260 | 186,762 | 304,342 |
| BACHELOR'S DEGREE OR HIGHER | 11,119 | 67,073 | 106,379 |
| AVERAGE HH INCOME | \$92,362 | \$105,048 | \$103,278 |

Drive Time Map

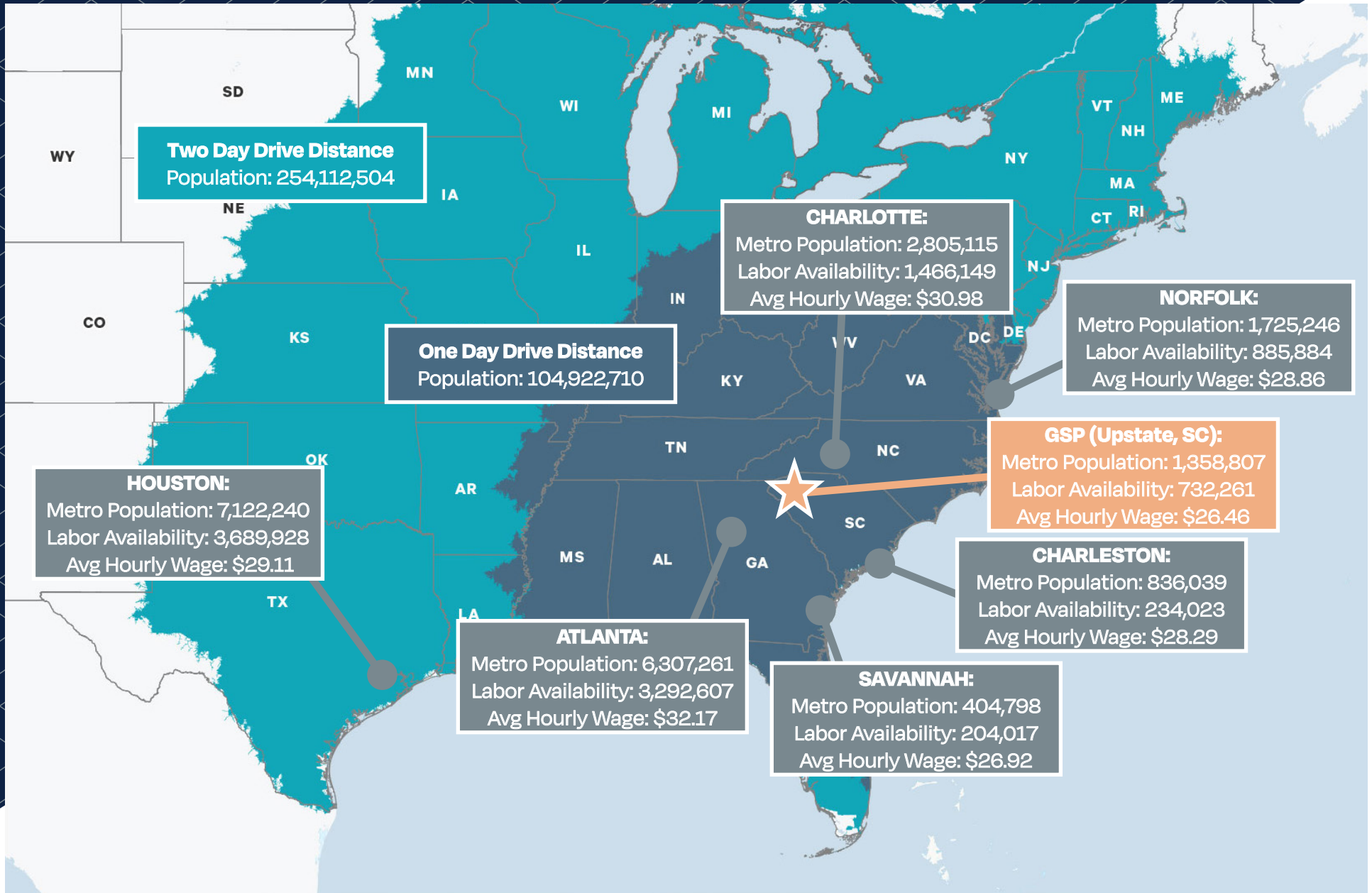



Contact Us:

Trey Pennington, SIOR
Executive Vice President
+1 864 527 6095
trey.pennington@cbre.com

Jeff Benedict, SIOR
First Vice President
+1 864 235 1961
jeff.benedict@cbre.com

Tripp Speaks
Associate
+1 864 235 6196
tripp.speaks@cbre.com