

The Promenade at Park Place



Office Space FOR LEASE

410 Park Place Blvd, Clearwater, Florida
430 Park Place Blvd, Clearwater, Florida

CBRE

410 Park Place

6,993 SF Available

430 Park Place

7,270 SF Available

Discover an attractive office positioned at the entrance to Clearwater and in the center of everything!

- Park-like Setting with Abundant Foliage
- 5/1,000 SF Parking
- Centrally Located with Direct Access to the Courtney Campbell Bridge, Bayside Bridge, and US Hwy 19 N
- Impressive Tenant Mix
- Secured Building, Accessible 24/7/365
- On-site Engineering & Management Office
- Minutes to Tampa, Downtown Clearwater, and Clearwater Beach

Neighboring Tenants



BAUSCH + LOMB

Verifone®

Nearby Retail

Perkins®



SMOKEY
BONES



CARRABBA'S
ITALIAN GRILL

TARGET



Single story building
with abundant light in
a park-like setting



Space can be delivered per
Tenant's specifications



Tenant controls its own
electricity usage



410 PARK PLACE BLVD
SUITE 100
6,993 SF

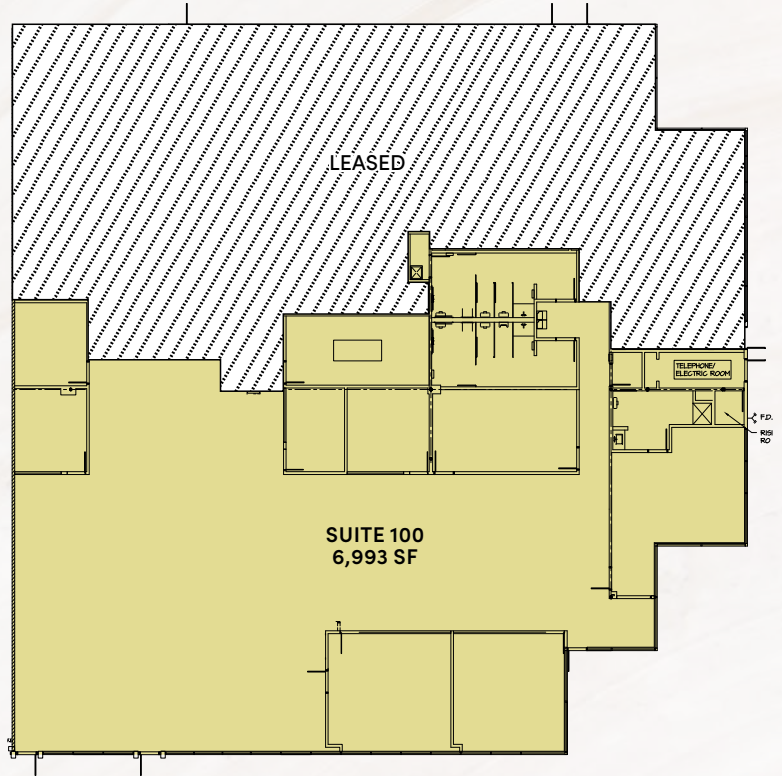

430 PARK PLACE BLVD
SUITE 100
7,270 SF

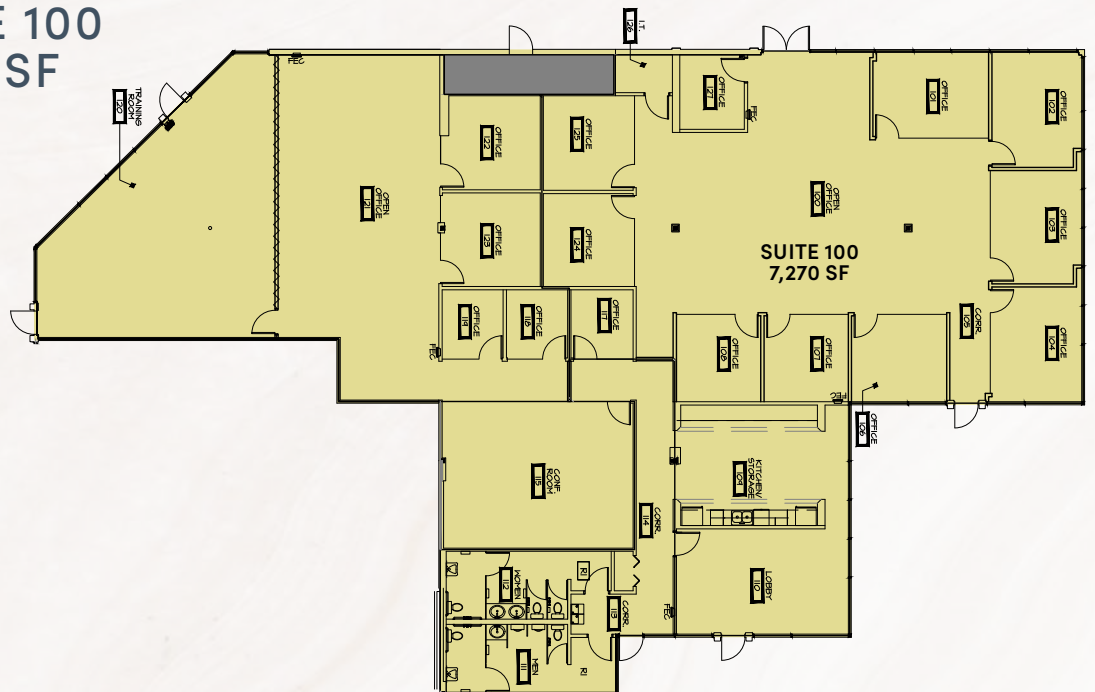

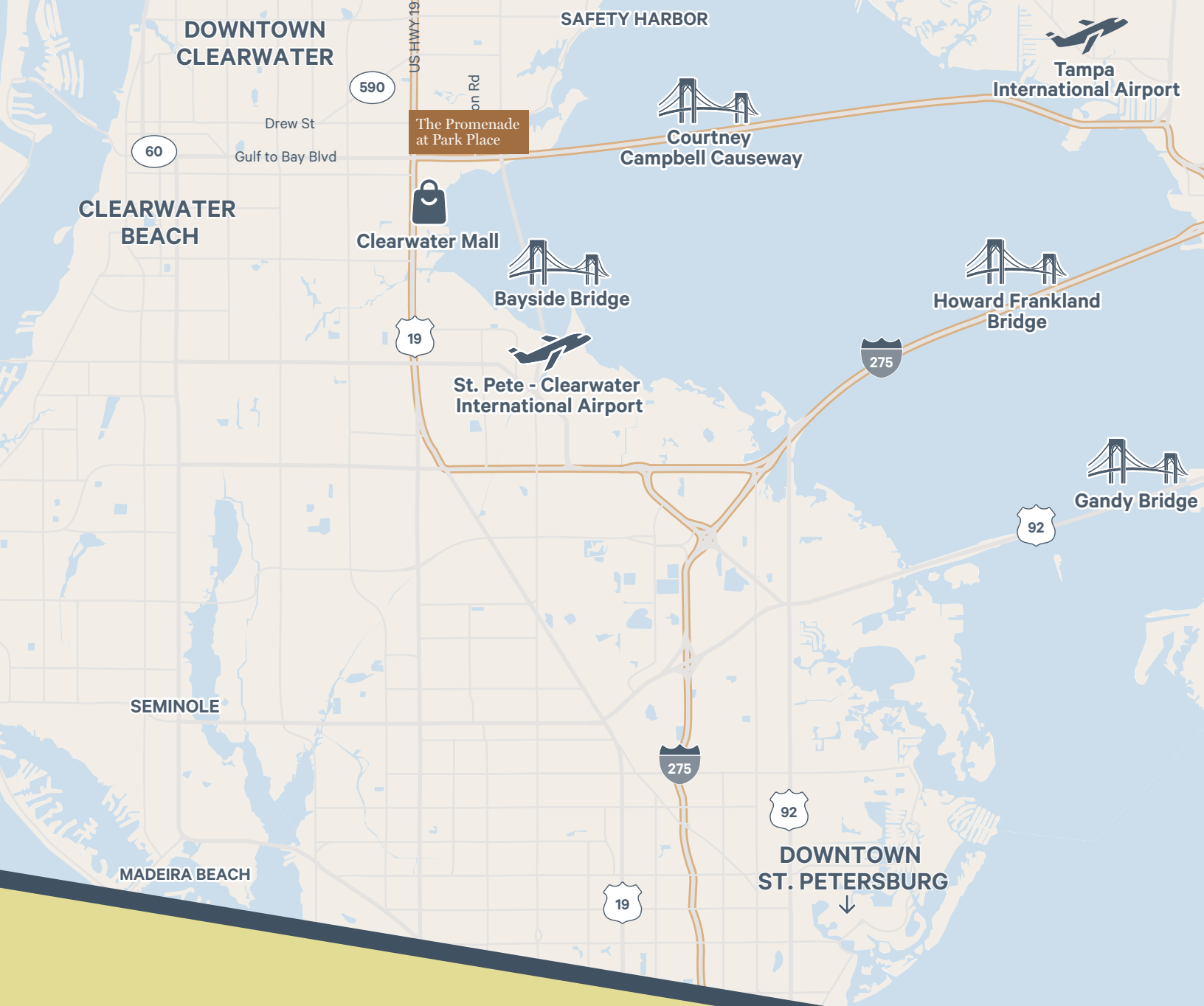

Please Contact:

Kristin Kenney
First Vice President
+1 985 788 5105
kristin.kenney@cbre.com

Kelley Matheson
Senior Vice President
+1 813 273 8489
kelley.matheson@cbre.com

410 Park Place Blvd, Clearwater, Florida
430 Park Place Blvd, Clearwater, Florida



©2026 CBRE, Inc. All rights reserved. This information has been obtained from sources believed reliable, but has not been verified for accuracy or completeness. Any projections, opinions, or estimates are subject to uncertainty. The information may not represent the current or future performance of the property. You and your advisors should conduct a careful, independent investigation of the property and verify all information. Any reliance on this information is solely at your own risk. CBRE and the CBRE logo are service marks of CBRE, Inc. and/or its affiliated or related companies in the United States and other countries. All other marks displayed on this document are the property of their respective owners. Photos herein are the property of their respective owners and use of these images without the express written consent of the owner is prohibited.